

ASBESTOS SURVEY REPORT

HG MAINT (ID: 456)

COLUMBUS, MS

Columbus AFB, MS

Prepared for:
COLUMBUS AIR FORCE BASE
14 Ces/cev
Columbus AFB, MS 39710-6010

Prepared by:
Columbus Air Force Base
December 16, 2005
Project Number:

Prepared By:



Reviewed By:



Table of Contents

Section:

	Executive Summary
1	Introduction
2	Description of Building Construction and Systems
3	Summary of Findings for Suspect Materials
4	Material Information Tables

Appendices:

A	Definitions of Terms and Assessment Criteria
B	Bulk Sampling Protocol and Analytical Methods

Executive Summary

Hub Testing Laboratory, Inc. (Hub) was retained by Columbus Air Force Base to perform a National Emissions Standard for Hazardous Air Pollutants (NESHAPS) style asbestos survey of the HG MAINT (Building ID: 456), to determine the locations of accessible and to the extent feasible, inaccessible friable and non-friable asbestos containing building materials (ACBM).

Friable materials are materials that can be reduced to powder with hand pressure such as fireproofing, sprayed-on acoustic ceilings, pipe insulation, and other thermal systems insulation. All other materials such as floor tile, ceiling tile, adhesives, plaster, stucco, and sheet rock mudding compounds are considered non-friable materials. Because friable materials are more likely to release asbestos fibers into the air when disturbed than non-friable materials, friable materials are considered a greater health concern.

No friable asbestos-containing materials were observed in the building.

Asbestos was detected or assumed in the following non-friable materials:

Wall - Sheetrock

Section 1 Introduction

This report is based on requirements of the National Emissions Standards of Hazardous Air Pollutants (NESHAPS) requirements for renovation and/or demolition projects.

Friable materials are materials that can be reduced to powder with hand pressure such as fireproofing, sprayed-on acoustic ceilings, pipe insulation, and other thermal systems insulation. All other materials such as floor tile, ceiling tile, adhesives, plaster, stucco, and sheet rock mudding compounds are considered non-friable materials. Because friable materials are more likely to release asbestos fibers into the air when disturbed than non-friable materials, friable materials are considered a greater health concern.

All identified suspect asbestos-containing materials are summarized in Section 3. Materials testing positive for asbestos including material assessments, recommended response actions, and quantities are described in Section 4. Removal cost estimates for asbestos-containing materials are included in Section 5.

Removal cost estimates are for budgeting purposes only and should not be used as a quote for removal of the materials. It is not our recommendation to remove these materials unless they are beyond repair, or planned demolition or renovation activities will disturb the materials. Estimates are based on recent pricing we have received from contractors performing similar work and may vary from actual prices obtained due to the actual scope of work, quantity of material removed, control measures specified and contractor work loads.

On Sunday, October 20, 2002 (Inspector 1 name missing),(Title1 missing) from Hub, performed an asbestos survey of the building(s) in accordance with the Asbestos Hazard and Emergency Response Act of 1987 (AHERA).

DISCLAIMER

This report is prepared for the express use and benefit of Columbus Air Force Base, its agents and employees. The information in this report or portions thereof may be required to be included in notifications to employees, contractors or other visitors to the building(s). This report is not intended to be used as a specification or work plan for any of the work suggested or recommended in this report.

This report is based upon conditions and practices observed at the property and information made available to the surveyor. This report does not intend to identify all hazards or unsafe practices, nor to indicate that other hazards or unsafe practices do not exist at the premises.

Section 2 Description of Building Construction and Systems

Number of Floors: 1

Year Built: 1958

Total Square Footage: 46,582

Building Description/Comments:

A

Comments:

2 OIL FIRED AIR HANDLERS, ONE IN EACH MECH ROOM.

Section 3 Summary of Findings for Suspect Materials

The following table is a list of all materials at this building which were tested for the presence of asbestos or were assumed to contain asbestos along with overall sample results. Complete information on asbestos containing materials is included in Section 4 of this report.

Each unique material within the building is assigned a unique HM number by the surveyor at the time the survey is performed.

Section 3 and Section 4 are organized by building, surfacing, thermal systems insulation, flooring, walls, ceilings, roofing and miscellaneous materials.

Site Information

HG MAINT (Site ID: COLU)
Building: 456

Columbus AFB, MS

Survey Performed By
Hub Testing Laboratory, Inc.

Inspector

Inspection Date

Sunday, October 20, 2002

Job Number

Client Information

Columbus Air Force Base
14 CES/CEV
Columbus AFB, MS 39710-6010

<i>Suspect Material</i>	<i>Category</i>	<i>HM Number</i>	<i>Material Location(s)</i>	<i>Floor</i>	<i>Asbestos Present?</i>
Pipe Insulation	TSI	PI-00N6	MI01HANGER	01	No
Hvac - Flexible Duct/flex Duct Joint	TSI	HFLEX-00A1	MR01MER1	01	No
			MR01MER2	01	No
Mech Equip. - Gasket	HVAC	MGASKT-00N5	MR01MER1	01	No
			MR01MER2	01	No
Domestic Hot Water Tank	TSI	DHWT-00N4	TO01BR	01	No
Misc. Floor - Vinyl Composite Tile	Flooring	FLVCT-001	OF01OFC	01	No
Misc. Floor - Vinyl Composite Tile	Flooring	FLVCT-003	TO01BR	01	No
Wall - Wall Insulation Batts	TSI	WLIN-00N7	MI01HANGER	01	No
Board Type Wall - Sheetrock	Walls	WLSH-004	MR01MER1	01	Yes
			MR01MER2	01	Yes

Site Information

HG MAINT (Site ID: COLU)
Building: 456

Survey Performed By
 Hub Testing Laboratory, Inc.

Inspection Date
 Sunday, October 20, 2002

Suspect Material	Category	HM Number	Material Location(s)	Floor	Asbestos Present?
Mudding Compound Associated with new sheetrock	Walls	JM-008	TO01BR	01	No
Board Type Ceiling - Lay-in Tile	Ceilings	CLLI-002	OF01OFC	01	No
Ceiling - Sheetrock	Ceilings	CLSH-00N3	TO01BR	01	No
Ceiling - Insulation Batts	TSI	CLIN-00N2	MI01HANGER	01	No
Roofing Material Metal	Roofing	RM-010	RF0RROOF	0R	0
Insulation Batts	Miscellaneous	BATT-00N1	OF01OFC	01	No
Misc Caulking Material	Miscellaneous	CAULK-009	EX0XEXT	0X	No

Section 4 Material Information Tables

Site Information
HG MAINT (Site ID: COLU)
Building: 456

Client Information
 Columbus Air Force Base
 14 CES/CEV
 Columbus AFB, MS 39710-6010

Columbus AFB, MS

Survey Performed By
 Hub Testing Laboratory, Inc.

Inspector

Inspection Date
 Sunday, October 20, 2002

Job Number

Material Description Pipe Insulation		Material Number pi-00n6	Asbestos Present? No
Material Category TSI	Friable Classification Friable	EPA Category Friable	Total Quantity 0
General Condition	Damage Category	Overall Material Assessment No Assessment, Non-asbestos	Recommended Response No Response Required, No Asbestos Detected
General Material Comments FIBERGLASS, NON-SUSPECT ACM.			

Material Location(s)	Floor	Location Quantity	Location Condition	Material Comments (by Location)
MI01HANGER	01	0		FIBERGLASS, NON-SUSPECT ACM.

Sample ID(s)	Sample Location(s)	Floor	Analyzed	Overall Result	Layer(s) Reported by Lab	Results by Layer

Material Description Hvac - Flexible Duct/flex Duct Joint		Material Number hflex-00a1	Asbestos Present? No
Material Category TSI	Friable Classification Friable	EPA Category Friable	Total Quantity 24
General Condition	Damage Category	Overall Material Assessment No Assessment, Non-asbestos	Recommended Response No Response Required, No Asbestos Detected
General Material Comments BLACK-WOVEN CLOTH MATERIAL. 2002, rubber and canvas			

Material Location(s)	Floor	Location Quantity	Location Condition	Material Comments (by Location)
MR01MER1	01	12		BLACK-WOVEN CLOTH MATERIAL.
MR01MER2	01	12		BLACK-WOVEN CLOTH MATERIAL.

Sample ID(s)	Sample Location(s)	Floor	Analyzed	Overall Result	Layer(s) Reported by Lab	Results by Layer

Material Description Mech Equip. - Gasket		Material Number mgaskt-00n5	Asbestos Present? No
Material Category HVAC	Friable Classification Non-Friable	EPA Category Category II	Total Quantity 0
General Condition	Damage Category	Overall Material Assessment No Assessment, Non-asbestos	Recommended Response No Response Required, No Asbestos Detected
General Material Comments EPOXY MATERIAL.			

Material Location(s)	Floor	Location Quantity	Location Condition	Material Comments (by Location)
MR01MER1	01	0		EPOXY MATERIAL.
MR01MER2	01	0		EPOXY MATERIAL.

Sample ID(s)	Sample Location(s)	Floor	Analyzed	Overall Result	Layer(s) Reported by Lab	Results by Layer

Section 4 Material Information Tables

Site Information

**HG MAINT (Site ID: COLU)
Building: 456**

Survey Performed By

Hub Testing Laboratory, Inc.

Inspection Date

Sunday, October 20, 2002

Matl Description Domestic Hot Water Tank		Material Number dhwt-00n4		Asbestos Present? No	
Matl Category TSI	Friable Classification Friable	EPA Category Friable	Total Quantity 0	Unit of Measure Square Feet	
General Condition	Damage Category	Overall Material Assessment No Assessment, Non-asbestos		Recommended Response No Response Required, No Asbestos Detected	
General Material Comments FIBERGLASS, NON-SUSPECT ACM.					
Material Location(s) TO01BR	Floor 01	Location Quantity 0	Location Condition	Material Comments (by Location) FIBERGLASS, NON-SUSPECT ACM.	
Sample ID(s)	Sample Location(s)	Floor	Analyzed	Overall Result	Layer(s) Reported by Lab Results by Layer

Matl Description Misc. Floor - Vinyl Composite Tile		Material Number flvct-001		Asbestos Present? No	
Matl Category Flooring	Friable Classification Non-Friable	EPA Category Category II	Total Quantity 480	Unit of Measure Square Feet	
General Condition	Damage Category	Overall Material Assessment No Assessment, Non-asbestos		Recommended Response No Response Required, No Asbestos Detected	
General Material Comments 1' X 1' LIGHT GREY/BROWN/WHITE MOTTLED.					
Material Location(s) OF01OFC	Floor 01	Location Quantity 480	Location Condition	Material Comments (by Location) 1' X 1' LIGHT GREY/BROWN/WHITE MOTTLED.	
Sample ID(s)	Sample Location(s)	Floor	Analyzed	Overall Result	Layer(s) Reported by Lab Results by Layer
FLVCT-001-001	OF01OFC		Yes	BLD	1) 2) 3)
FLVCT-001-002	OF01OFC		Yes	BLD	1) 2) 3)
FLVCT-001-003	OF01OFC		Yes	BLD	1) 2) 3)

Matl Description Misc. Floor - Vinyl Composite Tile		Material Number flvct-003		Asbestos Present? No	
Matl Category Flooring	Friable Classification Non-Friable	EPA Category Category II	Total Quantity 0	Unit of Measure Square Feet	
General Condition	Damage Category	Overall Material Assessment No Assessment, Non-asbestos		Recommended Response Manage in Place	
General Material Comments 1' X 1' GREY/WHITE/BLACK MOTTLED.					
Material Location(s) TO01BR	Floor 01	Location Quantity 0	Location Condition	Material Comments (by Location) 1' X 1' GREY/WHITE/BLACK MOTTLED.	

Section 4 Material Information Tables

Site Information

HG MAINT (Site ID: COLU)
Building: 456

Survey Performed By
 Hub Testing Laboratory, Inc.

Inspection Date
 Sunday, October 20, 2002

Sample ID(s)	Sample Location(s)	Floor	Analyzed	Overall Result	Layer(s) Reported by Lab	Results by Layer
FLVCT-003-001	TO01BR		Yes	BLD	1) 2) 3)	
FLVCT-003-002	TO01BR		Yes	BLD	1) 2) 3)	
FLVCT-003-003	TO01BR		Yes	BLD	1) 2) 3)	

Wall - Wall Insulation Batts		Material Number wlin-00n7	Asbestos Present? No
Material Category TSI	Friable Classification Friable	EPA Category Friable	Total Quantity 0
			Unit of Measure Square Feet

General Condition	Damage Category	Overall Material Assessment No Assessment, Non-asbestos	Recommended Response No Response Required, No Asbestos Detected
-------------------	-----------------	---	---

General Material Comments
FIBERGLASS, NON-SUSPECT ACM.

Material Location(s)	Floor	Location Quantity	Location Condition	Material Comments (by Location)
MI01HANGER	01	0		FIBERGLASS, NON-SUSPECT ACM.

Sample ID(s)	Sample Location(s)	Floor	Analyzed	Overall Result	Layer(s) Reported by Lab	Results by Layer
--------------	--------------------	-------	----------	----------------	--------------------------	------------------

Board Type Wall - Sheetrock		Material Number wish-004	Asbestos Present? Yes
Material Category Walls	Friable Classification Non-Friable	EPA Category Category II	Total Quantity 570
			Unit of Measure Square Feet

General Condition	Damage Category	Overall Material Assessment Not Assessed under AHERA	Recommended Response Manage in Place
-------------------	-----------------	--	--

General Material Comments

Material Location(s)	Floor	Location Quantity	Location Condition	Material Comments (by Location)
MR01MER1	01	285		
MR01MER2	01	285		2002, damaged

Sample ID(s)	Sample Location(s)	Floor	Analyzed	Overall Result	Layer(s) Reported by Lab	Results by Layer
WLSH-004-001	MR01MER2		Yes	BLD	1) 2) 3)	
WLSH-004-002	MR01MER1		Yes	5%	1) 2) 3)	1-5 % Chrysotile
WLSH-004-003	MR01MER1		Yes	5%	1) 2) 3)	1-5 % Chrysotile

Section 4 Material Information Tables

Site Information

HG MAINT (Site ID: COLU)
Building: 456

Survey Performed By

Hub Testing Laboratory, Inc.

Inspection Date

Sunday, October 20, 2002

Matl Description Mudding Compound Associated with new sheetrock			Material Number jm-008	Asbestos Present? No
Matl Category Walls	Friable Classification Friable	EPA Category Friable	Total Quantity	Unit of Measure Each
General Condition	Damage Category	Overall Material Assessment No Assessment, Non-asbestos	Recommended Response No Response Required, No Asbestos Detected	
General Material Comments				

Material Location(s)	Floor	Location Quantity	Location Condition	Material Comments (by Location)
TO01BR	01			

Sample ID(s)	Sample Location(s)	Floor	Analyzed	Overall Result	Layer(s) Reported by Lab	Results by Layer
JM-008-456-1N	Associated with new		Yes	0%	1) Joint Compound 2) 3)	0
JM-008-456-2N	Associated with new		Yes	0%	1) Joint Compound 2) 3)	0

Matl Description Board Type Ceiling - Lay-in Tile			Material Number clli-002	Asbestos Present? No
Matl Category Ceilings	Friable Classification Friable	EPA Category Friable	Total Quantity 480	Unit of Measure Square Feet
General Condition	Damage Category	Overall Material Assessment No Assessment, Non-asbestos	Recommended Response No Response Required, No Asbestos Detected	
General Material Comments				

2' X 4' WHITE FISSURED PATTERN.

Material Location(s)	Floor	Location Quantity	Location Condition	Material Comments (by Location)
OF01OFC	01	480		2' X 4' WHITE FISSURED PATTERN.

Sample ID(s)	Sample Location(s)	Floor	Analyzed	Overall Result	Layer(s) Reported by Lab	Results by Layer
CLLI-002-001	OF01OFC		Yes	BLD	1) 2) 3)	
CLLI-002-002	OF01OFC		Yes	BLD	1) 2) 3)	
CLLI-002-003	OF01OFC		Yes	BLD	1) 2) 3)	
CLLI-002-003	OF01OFC		Yes	BLD	1) 2) 3)	

Section 4 Material Information Tables

Site Information

HG MAINT (Site ID: COLU)
Building: 456

Survey Performed By
Hub Testing Laboratory, Inc.

Inspection Date
Sunday, October 20, 2002

Material Description		Material Number	Asbestos Present?
Ceiling - Sheetrock		clsh-00n3	No
Material Category	Friable Classification	EPA Category	Total Quantity
Ceilings	Non-Friable	Category II	0
General Condition	Damage Category	Overall Material Assessment	Recommended Response
		No Assessment, Non-asbestos	No Response Required, No Asbestos Detected
General Material Comments			
UNTAPED AT SEAMS.			
Material Location(s)	Floor	Location Quantity	Location Condition
TO01BR	01	0	UNTAPED AT SEAMS.
Sample ID(s)	Sample Location(s)	Floor	Analyzed
Material Description		Material Number	Asbestos Present?
Ceiling - Insulation Batts		clin-00n2	No
Material Category	Friable Classification	EPA Category	Total Quantity
TSI	Friable	Friable	0
General Condition	Damage Category	Overall Material Assessment	Recommended Response
		No Assessment, Non-asbestos	No Response Required, No Asbestos Detected
General Material Comments			
FIBERGLASS, NON-SUSPECT ACM.			
Material Location(s)	Floor	Location Quantity	Location Condition
MI01HANGER	01	0	FIBERGLASS, NON-SUSPECT ACM.
Sample ID(s)	Sample Location(s)	Floor	Analyzed
Material Description		Material Number	Asbestos Present?
Roofing Material Metal		rm-010	0
Material Category	Friable Classification	EPA Category	Total Quantity
Roofing	Non-Friable	Category I	
General Condition	Damage Category	Overall Material Assessment	Recommended Response
		Not Assessed under AHERA	Manage in Place
General Material Comments			
metal roof			
Material Location(s)	Floor	Location Quantity	Location Condition
RF0RROOF	0R		
Sample ID(s)	Sample Location(s)	Floor	Analyzed

Section 4 Material Information Tables

Site Information

HG MAINT (Site ID: COLU)
Building: 456

Survey Performed By
 Hub Testing Laboratory, Inc.

Inspection Date
 Sunday, October 20, 2002

Matl Description Insulation Batts			Material Number batt-00n1	Asbestos Present? No
Matl Category Miscellaneous	Friable Classification Friable	EPA Category Friable	Total Quantity 0	Unit of Measure Square Feet
General Condition	Damage Category	Overall Material Assessment No Assessment, Non-asbestos	Recommended Response No Response Required, No Asbestos Detected	
General Material Comments FIBERGLASS, NON-SUSPECT ACM. ABOVE CEILING.				

Material Location(s)	Floor	Location Quantity	Location Condition	Material Comments (by Location)
OF01OFC	01	0		FIBERGLASS, NON-SUSPECT ACM. ABOVE CEILING.

Sample ID(s)	Sample Location(s)	Floor	Analyzed	Overall Result	Layer(s) Reported by Lab	Results by Layer
--------------	--------------------	-------	----------	----------------	--------------------------	------------------

Matl Description Misc Caulking Material			Material Number caulk-009	Asbestos Present? No
Matl Category Miscellaneous	Friable Classification Friable	EPA Category Category II	Total Quantity	Unit of Measure Linear Feet
General Condition	Damage Category	Overall Material Assessment No Assessment, Non-asbestos	Recommended Response No Response Required, No Asbestos Detected	
General Material Comments Silicone and new windows				

Material Location(s)	Floor	Location Quantity	Location Condition	Material Comments (by Location)
EX0XEXT	0X			

Sample ID(s)	Sample Location(s)	Floor	Analyzed	Overall Result	Layer(s) Reported by Lab	Results by Layer
--------------	--------------------	-------	----------	----------------	--------------------------	------------------

**COLUMBUS AIR FORCE BASE
BUILDING ASBESTOS STATUS REPORT - BUILDING 456**

Note: Information shown is incomplete. Contact CEV to coordinate SOW.

Survey Date:	Work Order No	Room_Type/Floor No	Sample Number	Sample Description	Asbestos Detected?	% TOT_ASB
12/6/2002	SCHNEIDER-2002		Associated with new sheetrock-JM-456-2N-008-A	Joint Compound	<input type="checkbox"/> Yes <input checked="" type="checkbox"/> No	0
12/6/2002	SCHNEIDER-2002		Associated with new sheetrock-JM-456-1N-008-A	Joint Compound	<input type="checkbox"/> Yes <input checked="" type="checkbox"/> No	0
2/9/1993	GALSON-1993		OF01OFC-CLLI-003-002-A	Ceiling Tile - Lay in	<input type="checkbox"/> Yes <input checked="" type="checkbox"/> No	0
2/9/1993	GALSON-1993		OF01OFC-CLLI-002-002-A	Ceiling Tile - Lay in	<input type="checkbox"/> Yes <input checked="" type="checkbox"/> No	0
2/9/1993	GALSON-1993		OF01OFC-CLLI-001-002-A	Ceiling Tile - Lay in	<input type="checkbox"/> Yes <input checked="" type="checkbox"/> No	0
9/11/1996	BIO_1996		GM960425-A	ridge insulation, inside	<input type="checkbox"/> Yes <input checked="" type="checkbox"/> No	0
FLOOR						
2/9/1993	GALSON-1993		OF01OFC-FLVCT-003-001-A	Vinyl Composite Tile Floor	<input type="checkbox"/> Yes <input checked="" type="checkbox"/> No	0
2/9/1993	GALSON-1993		OF01OFC-FLVCT-002-001-A	Vinyl Composite Tile Floor	<input type="checkbox"/> Yes <input checked="" type="checkbox"/> No	0
2/9/1993	GALSON-1993		OF01OFC-FLVCT-001-001-A	Vinyl Composite Tile Floor	<input type="checkbox"/> Yes <input checked="" type="checkbox"/> No	0
2/9/1993	GALSON-1993		TO01BR-FLVCT-003-003-A	Vinyl Composite Tile Floor	<input type="checkbox"/> Yes <input checked="" type="checkbox"/> No	0
2/9/1993	GALSON-1993		TO01BR-FLVCT-002-003-A	Vinyl Composite Tile Floor	<input type="checkbox"/> Yes <input checked="" type="checkbox"/> No	0
2/9/1993	GALSON-1993		TO01BR-FLVCT-001-003-A	Vinyl Composite Tile Floor	<input type="checkbox"/> Yes <input checked="" type="checkbox"/> No	0
WALL						

COLUMBUS AIR FORCE BASE

BUILDING ASBESTOS STATUS REPORT - BUILDING 456

Note: Information shown is incomplete. Contact CEV to coordinate SOW.

Attachment 6

FA3022-14-R-0002

Page 16 of 20

Survey Date:	Work Order No	Room_Type/ Floor No	Sample Number	Sample Description	Asbestos Detected?	% TOT_ASB
2/9/1993	GALSON-1993		MRO1MER2-WLSH-001-004-A	Wall - sheetrock	<input type="checkbox"/> Yes <input checked="" type="checkbox"/> No	0
2/9/1993	GALSON-1993		MRO1MER1-WLSH-003-004-A	Wall - sheetrock	<input checked="" type="checkbox"/> Yes <input type="checkbox"/> No	5
2/9/1993	GALSON-1993		MRO1MER1-WLSH-002-004-A	Wall - sheetrock	<input checked="" type="checkbox"/> Yes <input type="checkbox"/> No	5

WALL

COLUMBUS AIR FORCE BASE - ASBESTOS HOMOGENEOUS AREA REPORT

Note: Information shown is incomplete. Contact CEV to coordinate SOW.

Building ID	Material Description	Location	ASB Status	Friability	Abatement Status
456	Wall - Wall Insulation Batts		No	Friable	
456	Roofing Material Metal	roof	0	Non-Friable	
456	Pipe Insulation		No	Friable	
456	Mudding Compound Associated with new sheetrock	Bathroom	No	Friable	
456	Misc. Floor - Vinyl Composite Tile		All Abated	Non-Friable	Completely Abated
456	Misc. Floor - Vinyl Composite Tile		No	Non-Friable	
456	Misc Caulking Material	Exterior	No	Friable	
456	Mech Equip. - Gasket		No	Non-Friable	
456	Insulation Batts		No	Friable	
456	Hvac - Flexible Duct/flex Duct Joint		No	Friable	
456	Domestic Hot Water Tank		No	Friable	
456	Ceiling - Sheetrock		No	Non-Friable	
456	Ceiling - Insulation Batts		No	Friable	
456	Board Type Wall - Sheetrock		Yes	Non-Friable	
456	Board Type Ceiling - Lay-in Tile		No	Friable	

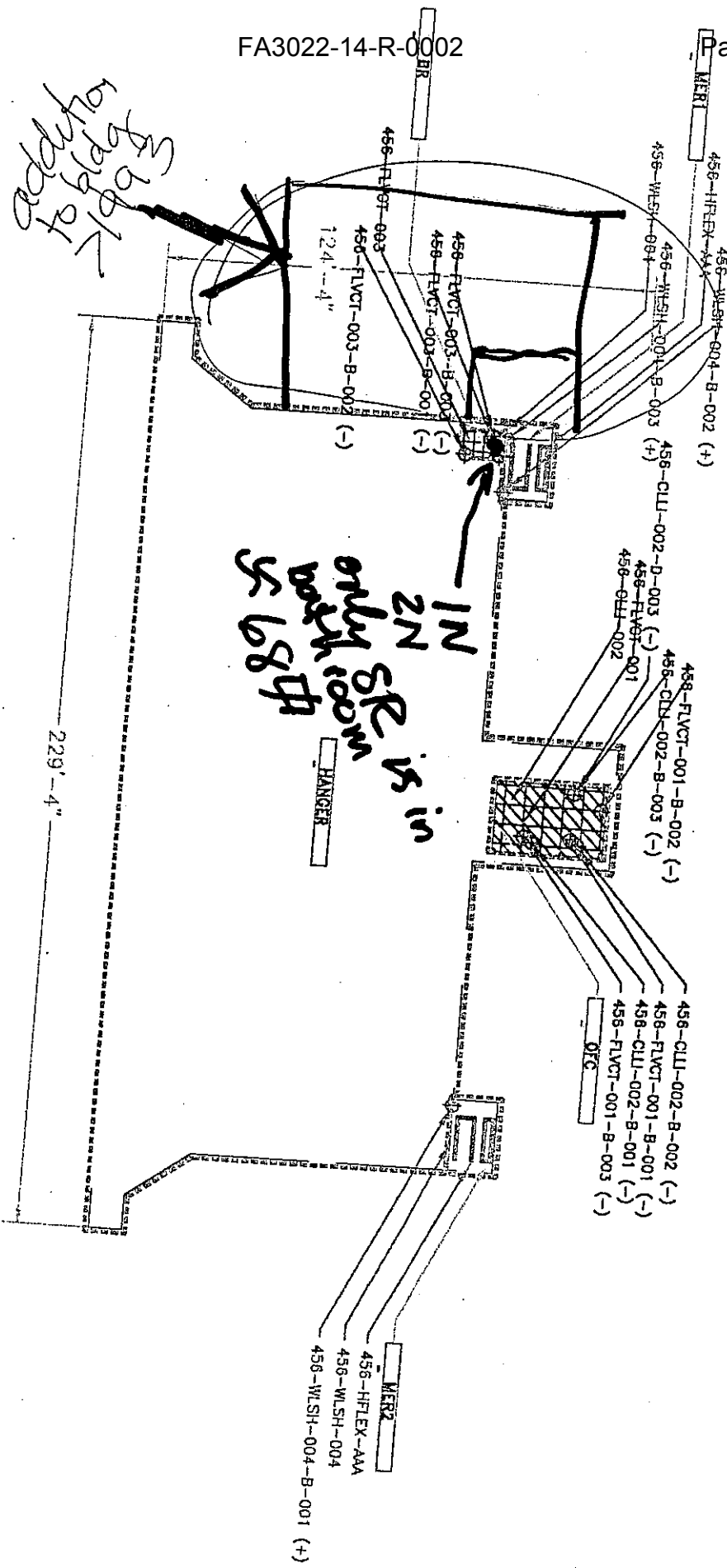

FIRST FLOOR PLAN

