

<b>AMENDMENT OF SOLICITATION/MODIFICATION OF CONTRACT</b>			1. CONTRACT ID CODE J	PAGE OF PAGES 1   2
2. AMENDMENT/MODIFICATION NO. 0001	3. EFFECTIVE DATE 22-Aug-2018	4. REQUISITION/PURCHASE REQ. NO.		5. PROJECT NO.(If applicable) FTEV 14-1057
6. ISSUED BY 1 SOCONS 350 TULLY ST. HURLBURT FIELD FL 32544	CODE FA4417	7. ADMINISTERED BY (If other than item 6) <b>See Item 6</b>		
8. NAME AND ADDRESS OF CONTRACTOR (No., Street, County, State and Zip Code)		X	9A. AMENDMENT OF SOLICITATION NO. FA441718R0019	
		X	9B. DATED (SEE ITEM 11) 08-Aug-2018	
			10A. MOD. OF CONTRACT/ORDER NO.	
			10B. DATED (SEE ITEM 13)	
CODE	FACILITY CODE			
11. THIS ITEM ONLY APPLIES TO AMENDMENTS OF SOLICITATIONS				
<input checked="" type="checkbox"/> The above numbered solicitation is amended as set forth in Item 14. The hour and date specified for receipt of offer <input type="checkbox"/> is extended, <input checked="" type="checkbox"/> is not extended. Offer must acknowledge receipt of this amendment prior to the hour and date specified in the solicitation or as amended by one of the following methods: (a) By completing Items 8 and 15, and returning <u>1</u> copies of the amendment; (b) By acknowledging receipt of this amendment on each copy of the offer submitted; or (c) By separate letter or telegram which includes a reference to the solicitation and amendment numbers. FAILURE OF YOUR ACKNOWLEDGMENT TO BE RECEIVED AT THE PLACE DESIGNATED FOR THE RECEIPT OF OFFERS PRIOR TO THE HOUR AND DATE SPECIFIED MAY RESULT IN REJECTION OF YOUR OFFER. If by virtue of this amendment you desire to change an offer already submitted, such change may be made by telegram or letter, provided each telegram or letter makes reference to the solicitation and this amendment, and is received prior to the opening hour and date specified.				
12. ACCOUNTING AND APPROPRIATION DATA (If required)				
13. THIS ITEM APPLIES ONLY TO MODIFICATIONS OF CONTRACTS/ORDERS. IT MODIFIES THE CONTRACT/ORDER NO. AS DESCRIBED IN ITEM 14.				
A. THIS CHANGE ORDER IS ISSUED PURSUANT TO: (Specify authority) THE CHANGES SET FORTH IN ITEM 14 ARE MADE IN THE CONTRACT ORDER NO. IN ITEM 10A.				
B. THE ABOVE NUMBERED CONTRACT/ORDER IS MODIFIED TO REFLECT THE ADMINISTRATIVE CHANGES (such as changes in paying office, appropriation date, etc.) SET FORTH IN ITEM 14, PURSUANT TO THE AUTHORITY OF FAR 43.103(B).				
C. THIS SUPPLEMENTAL AGREEMENT IS ENTERED INTO PURSUANT TO AUTHORITY OF:				
D. OTHER (Specify type of modification and authority)				
E. IMPORTANT: Contractor <input type="checkbox"/> is not, <input type="checkbox"/> is required to sign this document and return _____ copies to the issuing office.				
14. DESCRIPTION OF AMENDMENT/MODIFICATION (Organized by UCF section headings, including solicitation/contract subject matter where feasible.)  The purpose of this amendment is to provide details regarding temporary power requirements as identified in project drawings. A. Incorporate, Attachment 7, Temporary Power, Lighting and Cooling requirement document dated 03 Jul 2018 to solicitation attachments. B. All other terms and conditions remain unchanged.				
Except as provided herein, all terms and conditions of the document referenced in Item 9A or 10A, as heretofore changed, remains unchanged and in full force and effect.				
15A. NAME AND TITLE OF SIGNER (Type or print)		16A. NAME AND TITLE OF CONTRACTING OFFICER (Type or print)		
		TEL:	EMAIL:	
15B. CONTRACTOR/OFFEROR  _____ (Signature of person authorized to sign)	15C. DATE SIGNED	16B. UNITED STATES OF AMERICA  BY _____ (Signature of Contracting Officer)		16C. DATE SIGNED  22-Aug-2018

## SECTION SF 30 BLOCK 14 CONTINUATION PAGE

**SUMMARY OF CHANGES**

## SECTION J - LIST OF DOCUMENTS, EXHIBITS AND OTHER ATTACHMENTS

The following have been modified:

ATTACHMENTS

TITLE	DATE	No of Pages
1. Specifications FTEV 14-1057	01 Apr 2015	114
2. Drawing (Updated) FTEV 14-1057	25 Jul 2018	19
3. Schedule of Wage Rates Building-Decision Number: FL20170262	12 Jan 2018	5
4. Past Performance Questionnaire	Undated	3
5. Financial Questionnaire	Undated	1
6. Additional Contract Requirements	Undated	3
7. Temporary Power, Lighting and Cooling Reqs	03 Jul 2018	6

AMENDMENTS: Amendments issued to this solicitation will be part of any resultant contract and will be listed above at the time of award

(End of Summary of Changes)

Temporary Power, Lighting and Cooling – CP 1026756 Upgrade Electrical Service Hangar 90700 . This package is additional "contract documents" mentioned on sheet T-1 Work Phasing/Power Outage Notes 3.

The contractor is to provide temporary power, lighting and cooling to five areas of Hangar 90700 for the entire time (24/7) during the 30 day shutdown period. These areas will be occupied by the government during this period. The 5 areas are as follows and shown on the attached floorplan:

- Metal Shop (1<sup>st</sup> floor South Pylon)
- Wheel and Tire Shop (1<sup>st</sup> floor North Pylon)
- Break/Office area (1<sup>st</sup> floor North Pylon)
- South Dock Box (in Bay adjacent to South Pylon)
- North Dock Box (in Bay adjacent to North Pylon)

The requirements for each area are as follows:

Metal Shop, to include Tool Crib

- Provide temporary lighting (50 foot-candles minimum)
- Provide temporary cooling (maximum 80 degrees F)
- Provide temporary electric power to 16 pieces of equipment identified on Equipment List

Wheel and Tire Shop

- Provide temporary lighting (50 foot-candles minimum)
- Provide temporary cooling (maximum 80 degrees F)
- Provide temporary electric power to 6 pieces of equipment identified on Equipment List

Break/Office Area

- Provide temporary lighting (35 foot-candles minimum)
- Provide temporary cooling (maximum 80 degrees F)

South Dock Box

- Provide temporary power. Current feed is from 100 amp breaker located in panel shown on attached diagram.

North Dock Box

- Provide temporary power. Current feed is from 100 amp breaker located in panel shown on attached diagram.

All temporary power must be installed to meet OSHA and NFPA requirements. Wiring is preferred to be run overhead. If wiring is run on floor, floor cable covers must be utilized.

The contractor must submit for government approval, a detailed temporary power, lighting and cooling plan stating the methods and equipment used at least 90 days before the shutdown.

Eason Hangar Temporary 30-day power requirements

Sheet Metal shop

Item #	Equipment Name	Manufacturer	Model #	Voltage	1-Phase/3-Phase	Max Amps
				220V/230V		
				240V		
				440V/460V		
1	Drill Press	Dayton	2LKP9	230v	1-Phase	23a
2	Press (EEECSE023)	Accupress	710010	460v	3-Phase	32.5
3	Belt Sander	Kalamazoo	S6X60W	230v	3-Phase	6.4a
4	Shear (EEECSE038)	Accushear	650012	460v	3-Phase	51a
5	Bandsaw (EEECSE040)	Dake Johnson	V40	230v	3-Phase	6.36
6	Hydropress Control Box	Banner	MUC-1	230v	3-Phase	3a
7	Hydropress Motor	Baldor	BA1202F	460v	3-Phase	72a
8	Power Leaf Break	Dreis and Krump	PB 8187	440v	3-Phase	6.8a
9	Disk/Spindle Sander	Max	30DVS	230V	3-Phase	10a (estimated)
10	Eaton Leonard Roblix	Eaton Leonard	200SEHR	460v	3-Phase	60a
11	Single Flare	PHI	3CPV-5-4	240v	3-Phase	15a
12	Power Roller	Sesco	1-E/ 1820	230v	3-Phase	14a
13	30/70 Hydraulic Press (EEECSE041)	Personnel Hydraulic Press	PHP3070	460 VAC	3 phase	72
14	Power Roller (EEECSE010)	Rol Shear Inc.	1-E	220 VAC	3 phase	14
15	Sander (Small) (EEECSE026)	Burr King	750	230 VAC	3 phase	8.64

Sheet Metal Tool Room

Item #	Equipment Name	Manufacturer	Model #	Voltage	1-Phase/3-Phase	Max Amps
1	Tool Carousel	White Systems	EE1270-112	230v	3-Phase	30a

Wheel/Tire Shop

Item #	Equipment Name	Manufacturer	Model #	Voltage	1-Phase/3-Phase	Max Amps
1	Dual Tire Inflator Safety Cage	BAUER		5871007 220V	Phase 1	20AMPS
2	Oven Thermal Drying	Precision Quincy Co.	32-650	460V	PHASE 2	30AMPS
3	GRAYMILLS JET PARTS WASHER	GRAYMILLS CO.	PCS-6060F	460V	PHASE 3	132AMPS
4	UNIVERSAL WHEEL BUILD UP STAND	BAUER		8071007 240V	PHASE 3	30AMPS
5	TIRE BEAD BREAKER	REGENT	715J1000EX	240V	PHASE 3	5.2AMPS
6	FREEZER (REQ FOR BUSHINGS)	SCIENTEMP	34-15B	230V	PHASE 1	5AMPS

Office Area South Tower 1st Floor

- Temp Lighting
- Temp Cooling

Isodock - North

- Power to dock box

Isodock - South

- Power to dock box

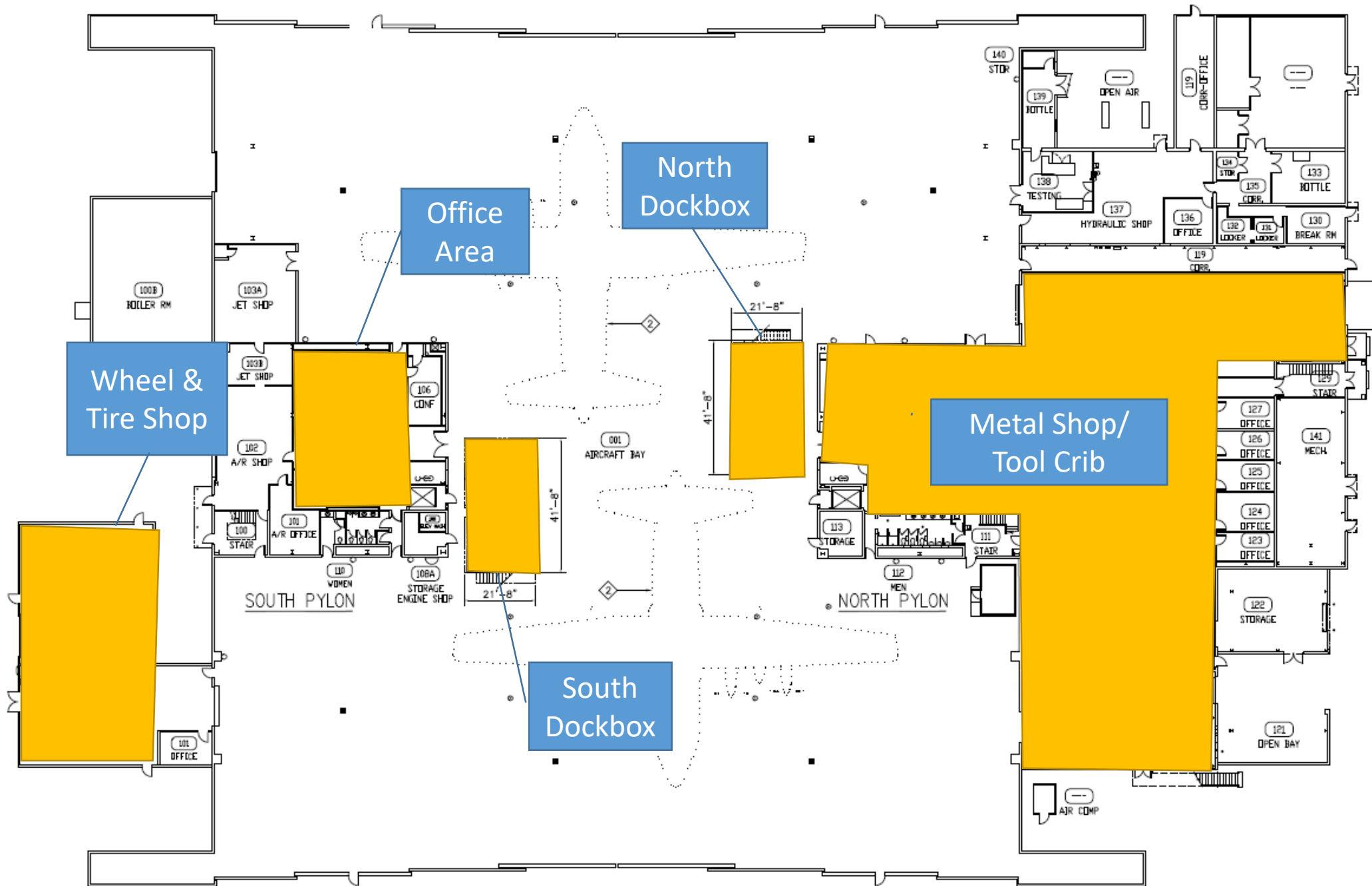

# Metal Shop/Tool Crib

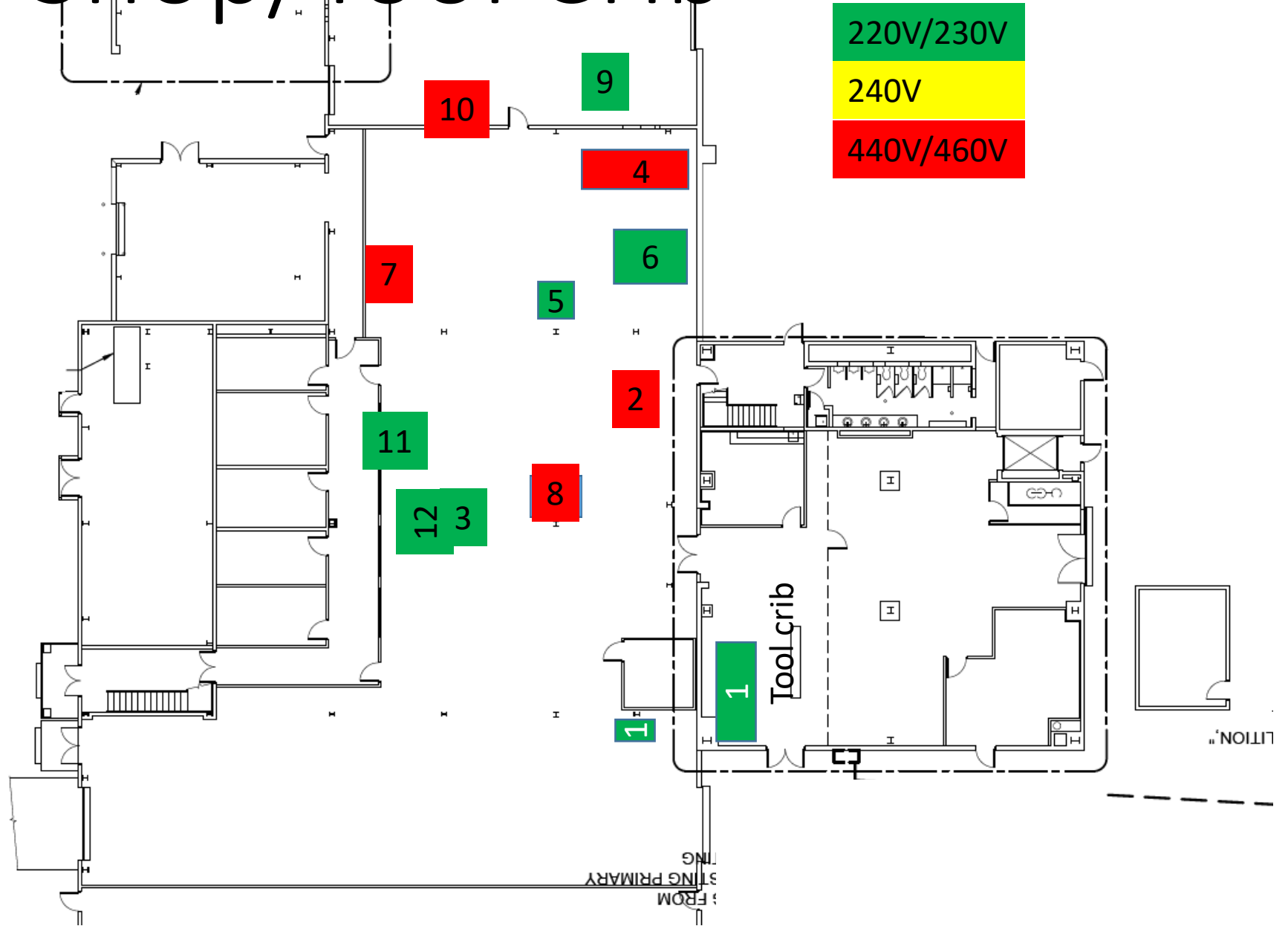

# Tire and Wheel Shop

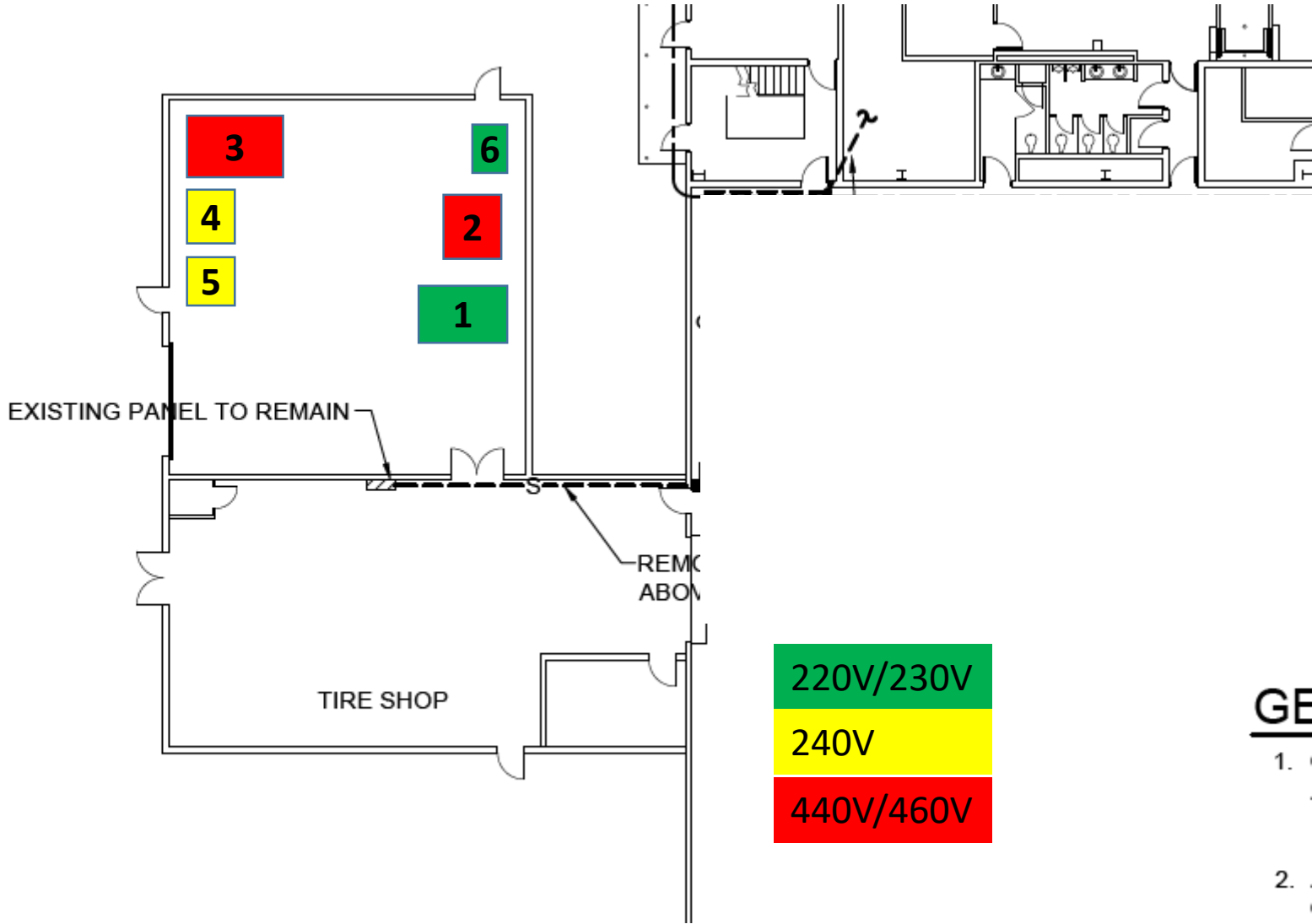

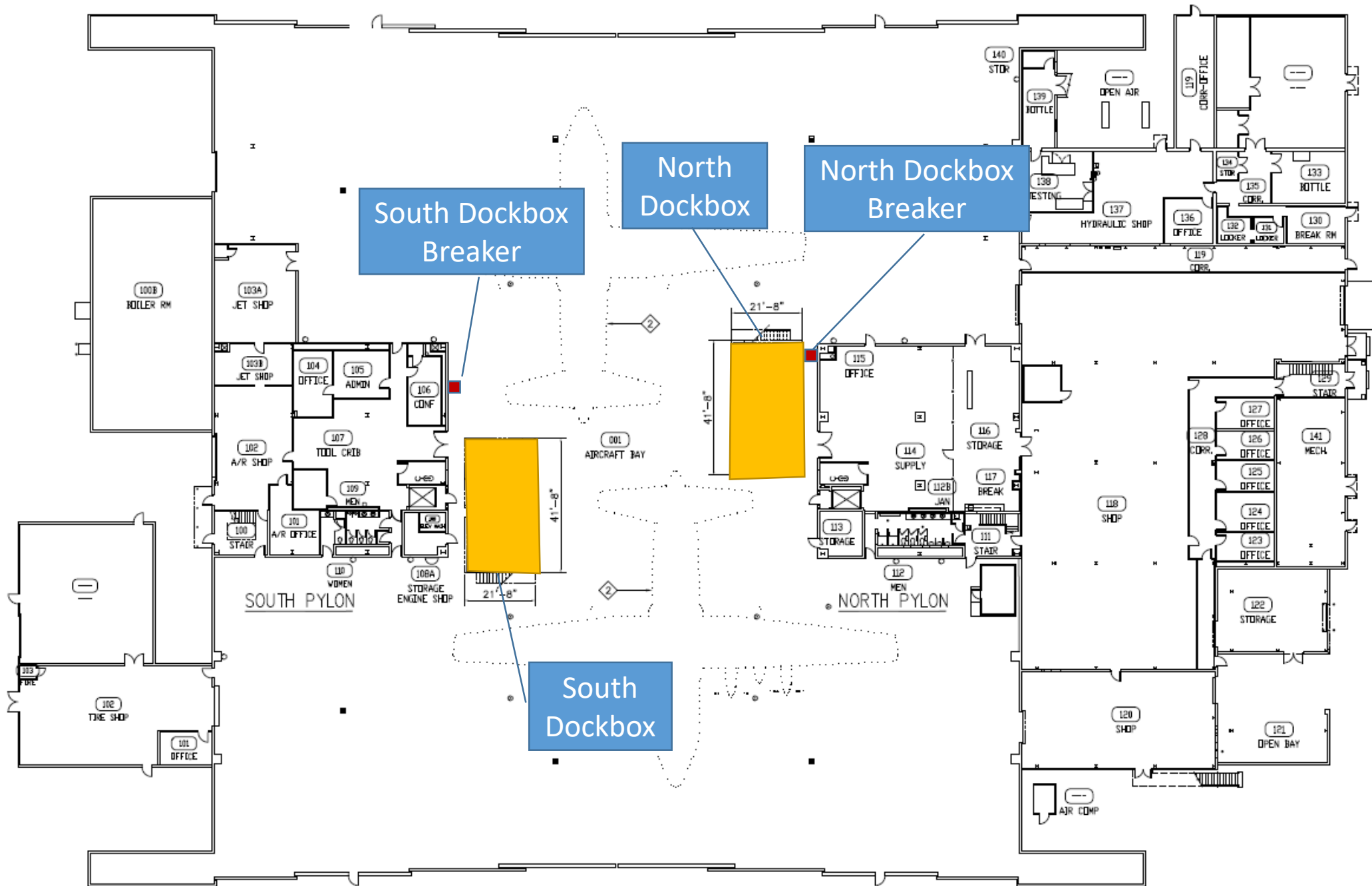

South Dockbox Breaker

North Dockbox

North Dockbox Breaker

South Dockbox