

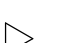



TELECOMMUNICATIONS SYMBOLS LEGEND	
ALL SYMBOLS SHOWN MAY NOT APPEAR IN ALL DRAWINGS. SYMBOLS ARE SHOWN SCHEMATIC AND MAY NOT BE TO SCALE.	
SYMBOL	DESCRIPTION
	DATA/TELEPHONE OUTLET. WALL MOUNTED - STUB 1" CONDUIT ABOVE ACCESSIBLE CEILING. MOUNT 15" AFF. PROVIDE WITH (1) BLUE CAT6A DATA DROP.
	DATA OUTLET. WALL MOUNTED - STUB 1" CONDUIT ABOVE ACCESSIBLE CEILING. MOUNT 15" AFF. PROVIDE WITH (1) BLUE CAT6A DATA DROP.
	FLOOR MOUNTED DATA OUTLET - FLUSH MOUNTED UNO. PROVIDE WITH (1) BLUE CAT6A DATA DROP.
	WIRELESS ACCESS POINT - PROVIDE WITH (2) BLUE CAT-6A DATA DROP. PROVIDE WITH 10' SLACK FOR ACCESS POINT PLACEMENT. TO BE TERMINATED IN CAT-6A DUAL JACK SURFACE MOUNT BOX (BISCUIT).
	WIREMESH CABLE TRAY
NOTES: 1. MOUNT ALL DEVICES AS INDICATED ABOVE, UNO ON PLAN 2. 48" AFF INDICATES TO TOP OF DEVICE 15" AFF INDICATES TO BOTTOM OF DEVICE ALL OTHER MOUNTING HEIGHTS INDICATE TO CENTERLINE OF DEVICE	

TELECOMMUNICATIONS GENERAL ABBREVIATIONS	
ABS	ABOVE BACK SPLASH
AFF	ABOVE FINISHED FLOOR
ARS	AREA OF RESCUE SYSTEM
BFC	BELOW FINISHED CEILING
BOCT	BOTTOM OF CABLE TRAY
C	CONDUIT
CB	CIRCUIT BREAKER
CLG	CEILING
EC	EMPTY CONDUIT
EP	ELECTRICAL PRIMARY
EX/(E)	EXISTING
F	FUSE
G	GROUND (EQUIPMENT)
GAP	GENERATOR ANNUNCIATOR PANEL
GF1	GROUND FAULT INTERRUPTER
IC	INTERRUPTING CAPACITY
IG	ISOLATED GROUND
MTD	MOUNT OR MOUNTED
MTG	MOUNTING
(N)	NEW
NL	NIGHT LIGHT
NC	NORMALLY CLOSED
N.O.	NORMALLY OPEN
NF	NONFUSED
NIC	NOT IN CONTRACT
RCPT(S)	RECEPTACLE(S)
PNL	PANEL
SD	SMOKE DAMPER
S.O.	SPACE ONLY
SP	SPARE
S.T.	SHUNT TRIP
SW	SWITCH
TYP	TYPICAL
UF	UNDERFLOOR
UG	UNDERGROUND
UNO	UNLESS NOTED OTHERWISE
WG	WIRE GUARD
WP	WEATHER PROOF
WP/WIU	WEATHERPROOF w/ WHILE-IN-USE COVER
XFMR	TRANSFORMER

TELECOMMUNICATIONS PLAN NOTES	
A. COORDINATE EXACT LOCATION AND MOUNTING HEIGHT OF ALL POWER SOURCE WIRING IN ACCORDANCE WITH ARCHITECTURAL MILLWORK. ALL INSTALLATIONS SHALL COMPLY WITH ADA REQUIREMENTS.	S. CATALOG NUMBERS REFERENCED THROUGHOUT THE DRAWINGS AND SPECIFICATIONS ARE INTENDED TO CONVEY A GENERAL UNDERSTANDING OF THE TYPE OF QUALITY OF THE PRODUCT REQUIRED. WHERE WRITTEN DESCRIPTIONS DIFFER FROM INFORMATION CONVEYED BY A CATALOG NUMBER, THE WRITTEN DESCRIPTION SHALL GOVERN. NO EXTRA CHARGE SHALL BE ALLOWED BECAUSE A CATALOG NUMBER IS FOUND TO BE INCOMPLETE OR OBSOLETE.
B. CONTRACTOR SHALL VERIFY ALL REQUIREMENTS BEFORE ANY ROUGH-IN IN ORDER TO COORDINATE MANUFACTURER'S DRAWINGS FOR EQUIPMENT LOCATION AND INSTALLATION ACCESSORIES.	T. FURNISH AND INSTALL APPROPRIATE BACKING IN WALLS AS REQUIRED FOR MOUNTING BRACKETS AND OTHER WALL MOUNTED EQUIPMENT PER MANUFACTURER REQUIREMENTS.
C. COORDINATE ROUTING FOR CONDUIT UP IN JOIST AND FOR SUSPENDING REQUIREMENTS IN ACCORDANCE WITH STRUCTURAL PLANS.	U. TELECOMMUNICATIONS BONDING CONDUCTOR SHALL BE MINIMUM SIZE #6 AWG STRANDED ANNEALED COPPER CONDUCTOR WITH GREEN INSULATED PVC JACKET. ENSURE GROUND CONTINUITY BY PROPERLY BONDING ALL APPROPRIATE CABLING, CLOSURES, CABINETS, SERVICE BOXES, AND FRAMEWORK TO TELECOMMUNICATIONS GROUNDING BUSBAR.
D. ALL INTERCOM, DATA, CAMERA, AND TV DEVICES SHALL BE STUBBED UP TO ABOVE ACCESSIBLE CEILING AND TO CABLE TRAY IF PRESENT. THE CONTRACTOR SHALL PROVIDE J-HOOKS AND CONDUITS TO EXTEND CABLING TO WALLS.	V. FURNISH AND INSTALL WIRE MESH CABLE TRAY AS SHOWN ON THE DRAWING SET.
E. ALL PENETRATIONS THROUGH FIRE RATED WALLS SHALL USE THE EZ PATH SERIES FIRE-RATED ZERO MAINTENANCE PATHWAY UNO. FOLLOW MANUFACTURER USAGE AND INSTALLATION INSTRUCTIONS. REFER TO DETAIL 9 ON SHEET T501.	W. ALL CONDUITS, CABLE TRAY, CABLE HOOKS AND OTHER RACEWAYS SHALL BE COORDINATED WITH OTHER TRADES PRIOR AND DURING BUILDING CONSTRUCTION TO AVOID DELAYS AND CONFLICTS.
F. CONDUITS SHALL BE REAMED AND COMPLETED WITH CONNECTORS AND INSULATED BUSHINGS AT BOTH ENDS.	X. RACEWAYS SHALL BE PROPERLY GROUNDED PER NEC.
G. BETWEEN ANY TWO PULL POINTS THERE SHALL BE NO CONDUIT WITH GREATER THAN 180 DEGREES OF BENDS OR EQUIVALENT.	Y. CABLES SHALL BE LABELED ON A VISIBLE PART OF THE CABLE WITHIN THREE TO SIX (3-6) INCHES OF TERMINATION POINT WITH SELF-LAMINATING LABELS VIA PANDUIT LABELER AND SOFTWARE.
H. WHERE CONDUIT LENGTH EXCEEDS 100FT AND/OR TWO 90 DEGREE BENDS OR EQUIVALENT PROVIDE PULL BOXES AS REQUIRED.	Z. LABELS SHALL BE VISIBLE IF FACEPLATE IS REMOVED AND NUMBERED SEQUENTIALLY BEGINNING CLOCKWISE FROM THE FIRST OUTLET TO THE LEFT OF THE MAIN ENTRANCE TO THE ROOM.
I. ALL ZONE CONDUITS (HOME RUN) FOR LOW VOLTAGE COMMUNICATIONS CABLING SHALL BE MARKED AT THEIR TERMINUS WITH A TAG THAT IDENTIFIES "DATA, INTERCOM, ETC" (ROOM NAME AND NUMBER) WHERE THE OTHER END OF THE CONDUIT TERMINATES.	AA. ALL TRENCHING, EXCAVATION, AND BACKFILL IS THE RESPONSIBILITY OF THE GENERAL CONTRACTOR.
J. ALL CABLES ABOVE CEILING SHALL BE <u>PLENUM RATED</u> . ALL CABLES BELOW SLAB SHALL BE INDOOR/OUTDOOR RATED.	BB. FURNISH AND INSTALL THROUGH-WALL FIRE RATED PATHWAY DEVICES PROVIDING AN F-RATING RATING EQUAL TO THE RATING OF THE BARRIER IN WHICH THE DEVICE IS INSTALLED AS REQUIRED.
K. FURNISH AND INSTALL 8"H X 4"W X 3/4" T VERTICALLY HUNG, GRADE AC, PLYWOOD IN COMMUNICATION ROOMS AS INDICATED ON PLANS. PAINT PLYWOOD WITH TWO COATS OF FIRE RETARDANT TO MATCH EXISTING WALL FINISH. COORDINATE WITH ARCHITECT, PRIME CONTRACTOR, AND OWNER FOR INSTALLATION OF BACKBOARD. REFER TO DRAWINGS FOR PROPOSED LOCATION AND DETAILS.	CC. COORDINATE EXACT LOCATION AND HEIGHTS FOR DATA AND VOICE OUTLETS WITH ELECTRICAL OUTLETS.
L. MINIMUM CONDUIT SIZE FOR TWISTED PAIR CABLING (LOW VOLTAGE) SHALL BE NOT SMALLER THAN 1" TRADE SIZE.	DD. THE PLACEMENT OF WIRELESS ACCESS POINTS SHOWN IN THE DIAGRAMS IS FOR ILLUSTRATIVE PURPOSES ONLY. THE CONTRACTOR IS REQUIRED TO CONDUCT A WIRELESS SITE SURVEY, INCLUDING A HEAT MAP AND WIRELESS PROPAGATION ANALYSIS, TO DETERMINE THE OPTIMAL PLACEMENT OF DEVICES.
M. THE CONTRACTOR SHALL FULLY REVIEW ALL ELECTRICAL POWER PLANS TO IDENTIFY ALL RESPONSIBILITIES AND SCOPE OF WORK.	
N. <u>DO NOT</u> ROUTE FIRE ALARM RELATED CABLING IN SAME CABLE TRAY, AS OTHER LOW VOLTAGE SYSTEMS. UTILIZE DEDICATED J-HOOKS OR CONDUITS FOR ALL FIRE ALARM RELATED CABLING.	
O. ABOVE CEILING CABLE SUPPORTING HARDWARE. IN CONJUNCTION WITH THE SPECIFIED CABLE TRAY, ACCEPTABLE METHOD INCLUDES BUT IS NOT LIMITED TO J-HOOKS. CABLE SHOULD BE PROPERLY SUPPORTED WITH J-HOOK PATHWAY INSTALLED EVERY 3-5 FT. CABLE CROSS SECTION AREA SHOULD BE CALCULATED TO A 40% RATIO.	
P. FURNISH AND INSTALL A COMPLETE HORIZONTAL AND VERTICAL 1-IN BEND RADIUS CONTROL TO HELP PREVENT DEGRADATION OF CABLE PERFORMANCE.	
Q. THE CONTRACTOR DOCUMENTS DEPICT LOW VOLTAGE SYSTEMS WHICH ARE INTENDED TO BE COMPLETE AND FUNCTIONING SYSTEMS.	
R. STRICTLY ADHERE TO ALL BICSI, EIA AND TIA RECOMMENDED INSTALLATION PRACTICES.	

TELECOMMUNICATIONS SHEET INDEX		
SHEET #	SHEET TITLE	
TN001	TELECOMMUNICATIONS GENERAL NOTES AND LEGENDS	
TN100	TELECOMMUNICATIONS SITE PLAN	
TN101	TELECOMMUNICATIONS OVERALL FLOOR PLAN	
TN102	TELECOMMUNICATIONS FLOOR PLAN NORTH	
TN103	TELECOMMUNICATIONS FLOOR PLAN SOUTH	
TN201	TELECOMMUNICATIONS ENLARGED PLANS	
TN401	TELECOMMUNICATIONS SCHEDULES	
TN501	TELECOMMUNICATIONS DETAILS I	
TN502	TELECOMMUNICATIONS DETAILS II	

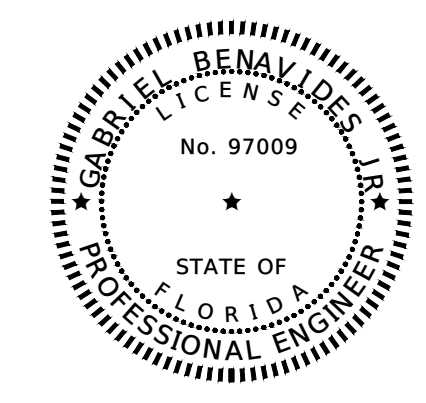

THIS ITEM HAS BEEN DIGITALLY SIGNED AND SEALED BY

ON THE DATE ADJACENT TO THE SEAL

PRINTED COPIES OF THIS DOCUMENT ARE NOT CONSIDERED SIGNED AND SEALED AND THE SIGNATURE MUST BE VERIFIED ON ANY ELECTRONIC COPIES.

No.	Date	Issue / Revision



2255 KILLEARN CENTER BLVD.  
SUITE 200  
TALLAHASSEE, FLORIDA 32309  
TEL. (850) 224-4400

GABRIEL BENAVIDES JR. P.E.  
PE NO. 97009

HALFF ASSOCIATES, INC.  
2255 KILLEARN CENTER BLVD.  
SUITE 200  
TALLAHASSEE, FL 32309

FLORIDA-ALABAMA TPO		
ROAD NO.	COUNTY	FINANCIAL PROJECT ID
NORTH W STREET	ESCAMBIA	451524-1-38-01

**TELECOMMUNICATIONS GENERAL**

**NOTES AND LEGENDS**

<b>DWG NO.</b>	TN001
<b>SHEET NO.</b>	

THE OFFICIAL RECORD OF THIS SHEET IS THE ELECTRONIC FILE DIGITALLY SIGNED AND SEALED UNDER RULE 61G15-23.004, F.A.C.



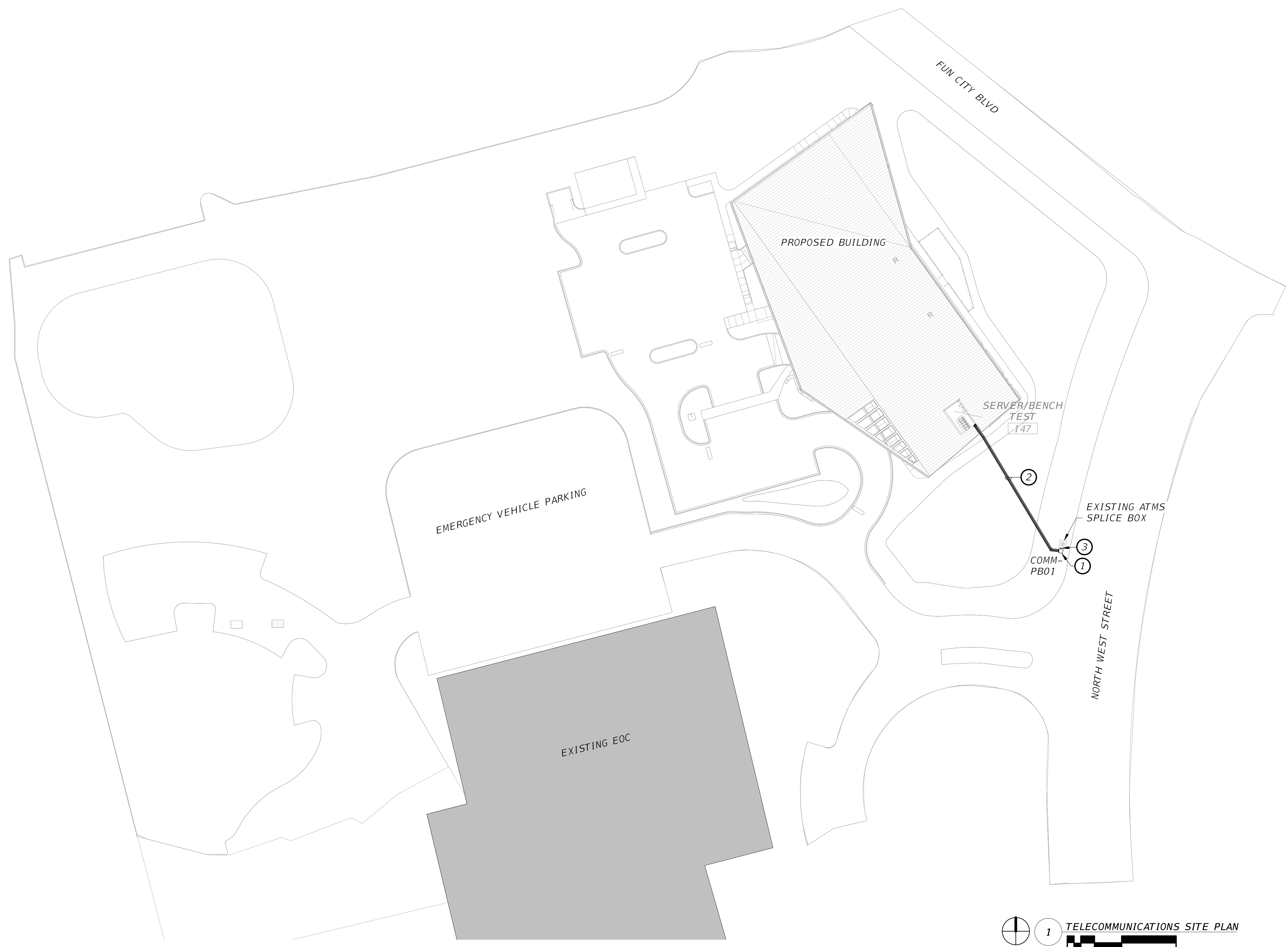

**GENERAL NOTES:**

A. REFER TO SHEET TN001 FOR TELECOMMUNICATIONS GENERAL LEGEND AND NOTES.

**KEY NOTES:**

1. PROVIDE WITH 36"X36" IN-GROUND ENCLOSURE EQUAL TO OLDCASTLE H-SERIES: 3636 WITH TIER 15 COVER FOR INTERNET SERVICE PROVIDER (ISP). CONTRACTOR TO ROUTE FLEXIBLE CONDUIT THROUGH BASE OF PULLBOX.
2. EXTEND (2) 4" CONDUITS FOR ISP AND (2) 2" SPARE CONDUITS FROM COMM-PB01 TO SERVER/BENCH TEST ROOM 146. TO BE BURIED AT DEPTH OF 36' BELOW GRADE. PROVIDE WITH TRACEABLE WIRE AND DETECTABLE WARNING TAPE TO BE BURIED AT A DEPTH OF 12" BELOW GRADE.
3. EXTEND (2) 2" CONDUITS FROM COMM-PB01 TO EXISTING ATMS SPLICE BOX. FIELD VERIFY DEPTH PRIOR TO ROUGH-IN. REFER TO SHEET ITS105.

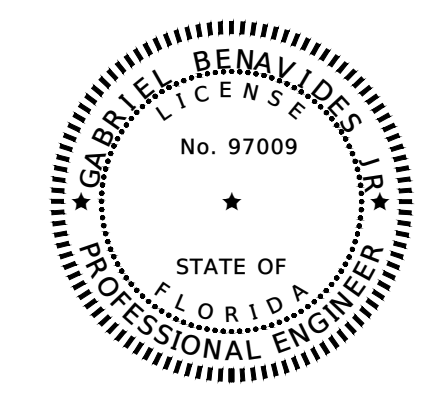
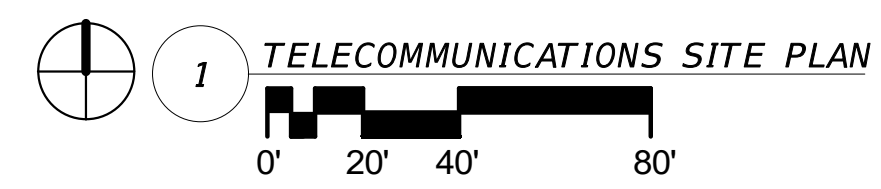

THIS ITEM HAS BEEN DIGITALLY SIGNED AND SEALED BY

ON THE DATE ADJACENT TO THE SEAL

PRINTED COPIES OF THIS DOCUMENT ARE NOT CONSIDERED SIGNED AND SEALED AND THE SIGNATURE MUST BE VERIFIED ON ANY ELECTRONIC COPIES.

No.	Date	Issue / Revision



GABRIEL BENAVIDES JR. P.E.  
PE NO. 97009

HALFF ASSOCIATES, INC.  
2255 KILLEARN CENTER BLVD.  
SUITE 200  
TALLAHASSEE, FL 32309

FLORIDA-ALABAMA TPO		
ROAD NO.	COUNTY	FINANCIAL PROJECT ID
NORTH W STREET	ESCAMBIA	451524-1-38-01

**TELECOMMUNICATIONS SITE PLAN**

<b>DWG NO.</b>	TN100
<b>SHEET NO.</b>	

THE OFFICIAL RECORD OF THIS SHEET IS THE ELECTRONIC FILE DIGITALLY SIGNED AND SEALED UNDER RULE 61G15-23.004, F.A.C.

**GENERAL NOTES:**  
 A. REFER TO SHEET TN001 FOR TELECOMMUNICATIONS GENERAL LEGEND AND NOTES.

**KEY NOTES:**  
 1. CONTRACTOR SHALL COORDINATE FINAL ROUTE OF CABLE TRAY WITH OTHER BUILDING SYSTEMS SUCH AS HVAC DUCT, CONDUIT, AND WATER LINES. PROVIDE BEST ROUTE IN A MULTI-DISCIPLINE SHOP DRAWINGS FOR REVIEW. MAKE FIELD ADJUSTMENTS AS NECESSARY FOR A FULL AND FUNCTIONAL SYSTEMS THATS INSTALLED IN ACCORDANCE WITH BICSI AND INDUSTRY STANDARDS.

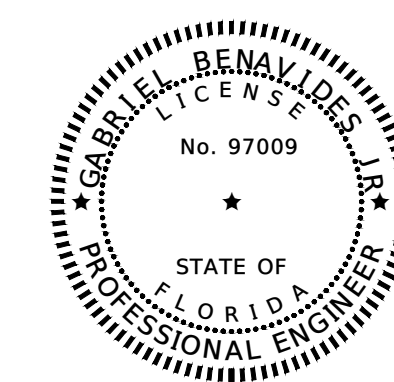
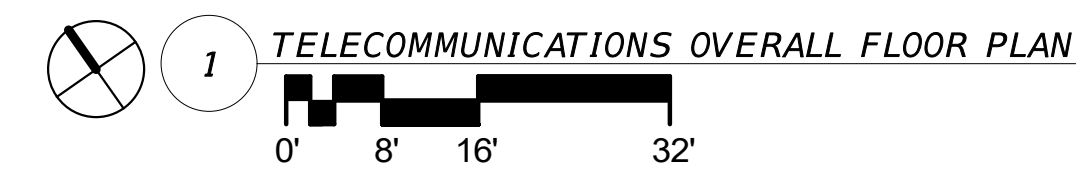
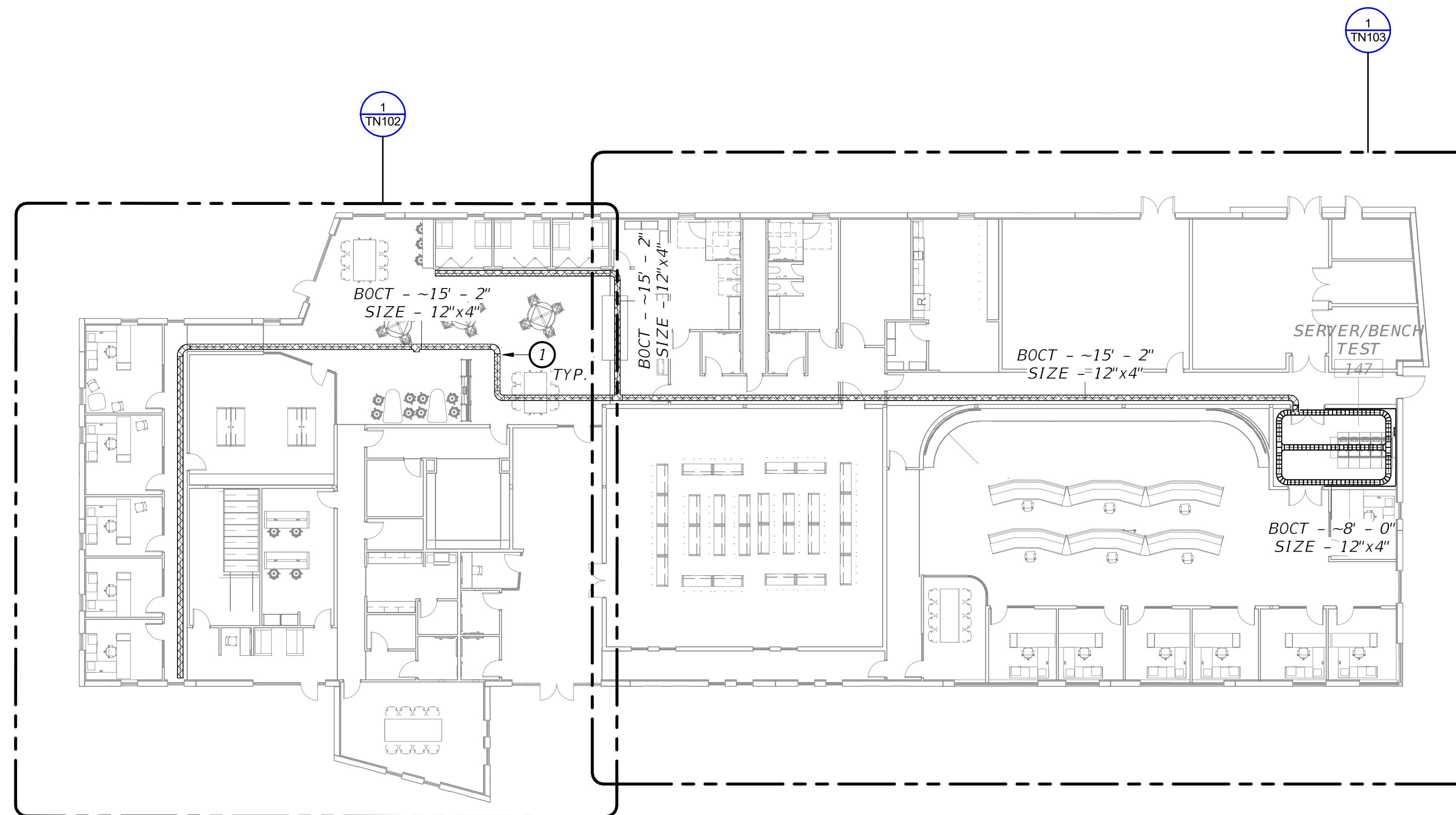

THIS ITEM HAS BEEN DIGITALLY SIGNED AND SEALED BY

ON THE DATE ADJACENT TO THE SEAL  
 PRINTED COPIES OF THIS DOCUMENT ARE NOT CONSIDERED SIGNED AND SEALED AND THE SIGNATURE MUST BE VERIFIED ON ANY ELECTRONIC COPIES.

No.	Date	Issue / Revision



GABRIEL BENAVIDES JR. P.E.  
 PE NO. 97009  
 HALFF ASSOCIATES, INC.  
 2255 KILLEARN CENTER BLVD.  
 SUITE 200  
 TALLAHASSEE, FL 32309

FLORIDA-ALABAMA TPO		
ROAD NO.	COUNTY	FINANCIAL PROJECT ID
NORTH W STREET	ESCAMBIA	451524-1-38-01

**TELECOMMUNICATIONS OVERALL FLOOR PLAN**

**DWG NO.**  
 TN101  
**SHEET NO.**

THE OFFICIAL RECORD OF THIS SHEET IS THE ELECTRONIC FILE DIGITALLY SIGNED AND SEALED UNDER RULE 61G15-23.004, F.A.C.





REF: 1 / TN103

REF: 1 / TN103

**GENERAL NOTES:**

A. REFER TO SHEET TN001 FOR TELECOMMUNICATIONS GENERAL LEGEND AND NOTES.

**KEY NOTES:**

1. EXTEND A 1" CONDUIT TO NEAREST WALL CAVITY CLOSEST TO CABLE TRAY. REFER TO DRAWING TN101 FOR SUGGESTED CABLE TRAY ROUTING. TYPICAL OF ALL FLOOR BOX DATA DROPS.

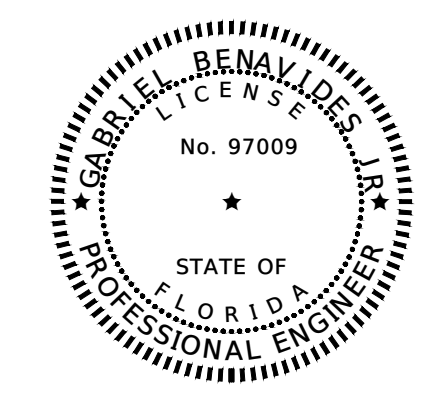
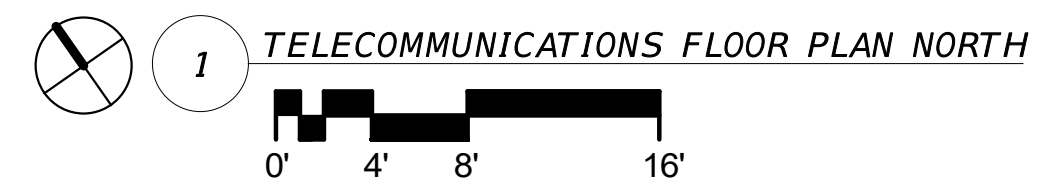

THIS ITEM HAS BEEN DIGITALLY SIGNED AND SEALED BY  
 ON THE DATE ADJACENT TO THE SEAL  
 PRINTED COPIES OF THIS DOCUMENT ARE NOT CONSIDERED SIGNED AND SEALED AND THE SIGNATURE MUST BE VERIFIED ON ANY ELECTRONIC COPIES.

No.	Date	Issue / Revision



GABRIEL BENAVIDES JR. P.E.  
 PE NO. 97009  
 HALFF ASSOCIATES, INC.  
 2255 KILLEARN CENTER BLVD.  
 SUITE 200  
 TALLAHASSEE, FL 32309

FLORIDA-ALABAMA TPO		
ROAD NO.	COUNTY	FINANCIAL PROJECT ID
NORTH W STREET	ESCAMBIA	451524-1-38-01

**TELECOMMUNICATIONS FLOOR PLAN NORTH**

<b>DWG NO.</b>	TN102
<b>SHEET NO.</b>	

THE OFFICIAL RECORD OF THIS SHEET IS THE ELECTRONIC FILE DIGITALLY SIGNED AND SEALED UNDER RULE 61G15-23.004, F.A.C.



REF. 1 / TN102

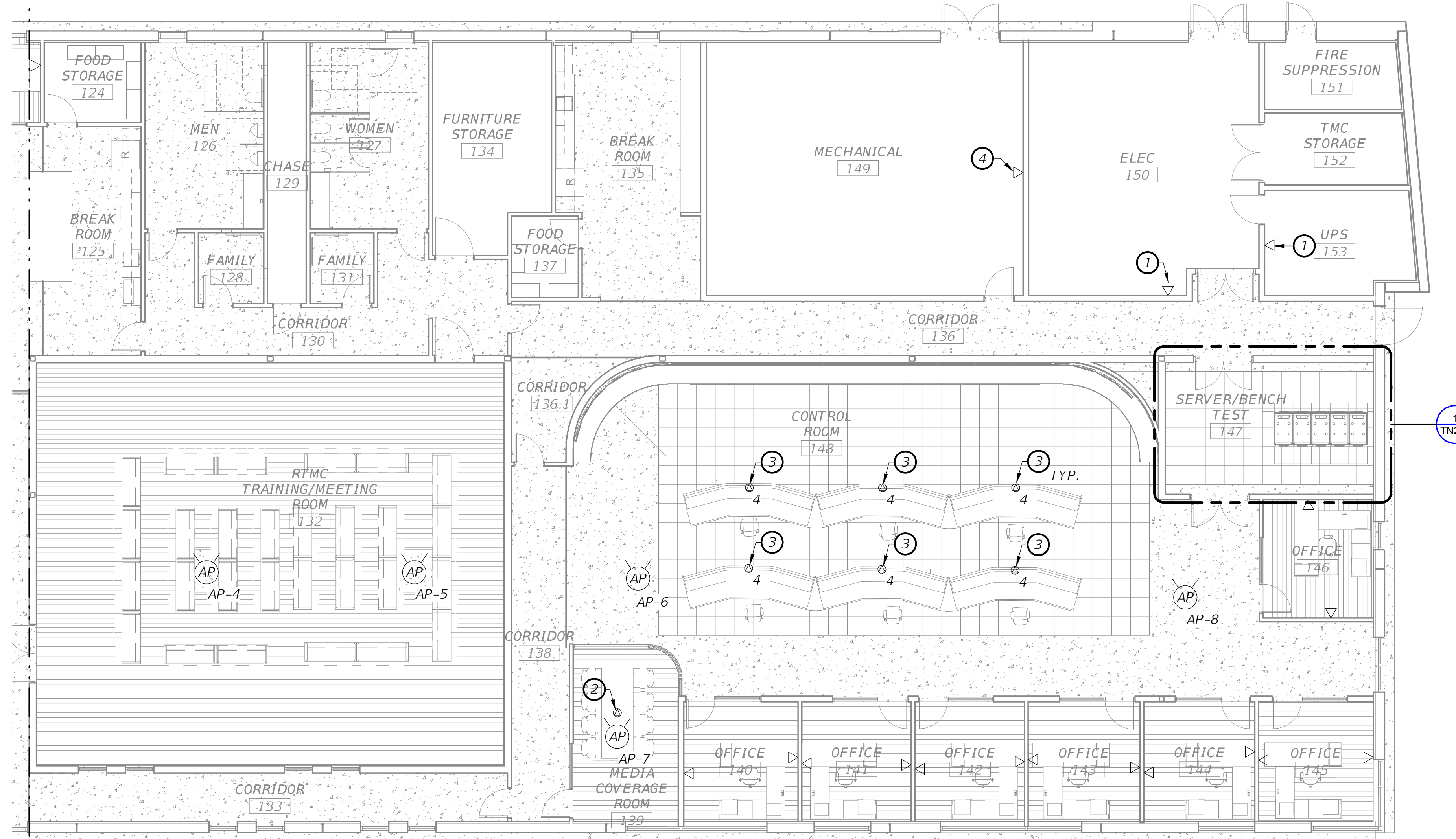

REF. 1 / TN102

**GENERAL NOTES:**

A. REFER TO SHEET TN001 FOR TELECOMMUNICATIONS GENERAL LEGEND AND NOTES.

**KEY NOTES:**

1. CONTRACTOR SHALL COORDINATE FINAL DATA DROP LOCATION WITH ELECTRICAL SHOP DRAWINGS AND FINAL ELECTRICAL/MECHANICAL EQUIPMENT PLACEMENT.
2. EXTEND A 1" CONDUIT TO NEAREST WALL CAVITY CLOSEST TO CABLE TRAY. REFER TO DRAWING TN101 FOR SUGGESTED CABLE TRAY ROUTING. TYPICAL OF ALL FLOOR BOX DATA DROPS.
3. J-HOOKS FASTENED TO THE ACCESS FLOOR PEDESTALS TO ROUTE CABLE UNDER RAISED FLOOR TO SERVER/BENCH TEST 147. REFER TO SHEET TN201 FOR PATHWAY PENETRATION THROUGH FIRE RATED WALL.
4. COORDINATE WITH MECHANICAL CONTRACTOR PRIOR TO ROUGH-IN.

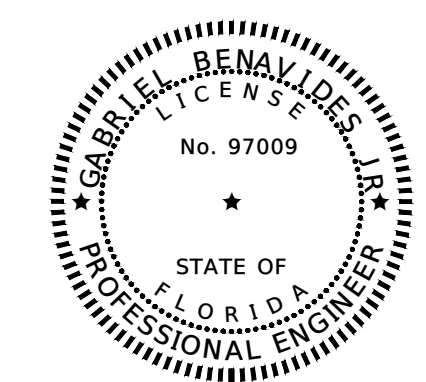
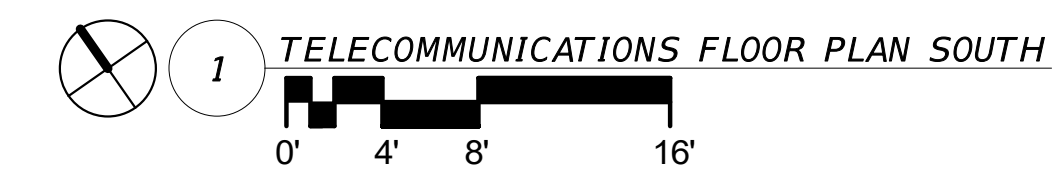

THIS ITEM HAS BEEN DIGITALLY SIGNED AND SEALED BY

ON THE DATE ADJACENT TO THE SEAL  
PRINTED COPIES OF THIS DOCUMENT ARE NOT CONSIDERED SIGNED AND SEALED AND THE SIGNATURE MUST BE VERIFIED ON ANY ELECTRONIC COPIES.

No.	Date	Issue / Revision



GABRIEL BENAVIDES JR. P.E.  
PE NO. 97009  
HALFF ASSOCIATES, INC.  
2255 KILLEARN CENTER BLVD.  
SUITE 200  
TALLAHASSEE, FL 32309

FLORIDA-ALABAMA TPO		
ROAD NO.	COUNTY	FINANCIAL PROJECT ID
NORTH W STREET	ESCAMBIA	451524-1-38-01

**TELECOMMUNICATIONS FLOOR  
PLAN SOUTH**

**DWG NO.**  
TN103  
**SHEET NO.**

THE OFFICIAL RECORD OF THIS SHEET IS THE ELECTRONIC FILE DIGITALLY SIGNED AND SEALED UNDER RULE 61G15-23.004, F.A.C.

**GENERAL NOTES:**  
 A. REFER TO SHEET TN001 FOR TELECOMMUNICATIONS GENERAL LEGEND AND NOTES.

- KEY NOTES:**
1. TELEPHONE BOARD - COVER ENTIRE SURFACE OF WALL WITH 3/4" PLYWOOD AND PAINT PLYWOOD WITH TWO COATS OF FIRE RETARDANT PAINT. PAINT COLOR SHALL BE WHITE. MOUNT PLYWOOD 8" AFF TO AVOID DAMAGING THE PLYWOOD WITH THE GRADE 'A' SURFACE EXPOSED.
  2. TELECOMMUNICATIONS GROUNDING BAR.
  3. (2) 4" CONDUIT STUB-UPS FOR ISP SERVICES. CONTRACTOR SHALL EXTEND CONDUIT 6-INCHES ABOVE FLOOR AND PROVIDE END CAP. EACH RACEWAY SHALL BE PROVIDED WITH TWO NYLON PULL STRINGS.
  4. (2) 2" CONDUIT STUB-UPS SPARES. CONTRACTOR SHALL EXTEND CONDUIT 6-INCHES ABOVE FLOOR AND PROVIDE END CAP. EACH RACEWAY SHALL BE PROVIDED WITH TWO NYLON PULL STRINGS.
  5. FOR EVERY FIRE RATED PENETRATED WALL, PROVIDE ZERO MAINTENANCE EZ-PATH SLEEVES TO RETAIN FIRE RATING ON WALL.
  6. PROVIDE WITH 12"X4" LADDER CABLE TRAY SYSTEM.
  7. (2) 1-1/2" CONDUITS FROM SERVER/BENCH TEST 147 TO ABOVE ROOF LINE CAPPED.

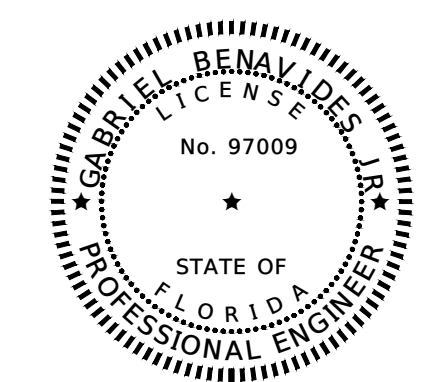
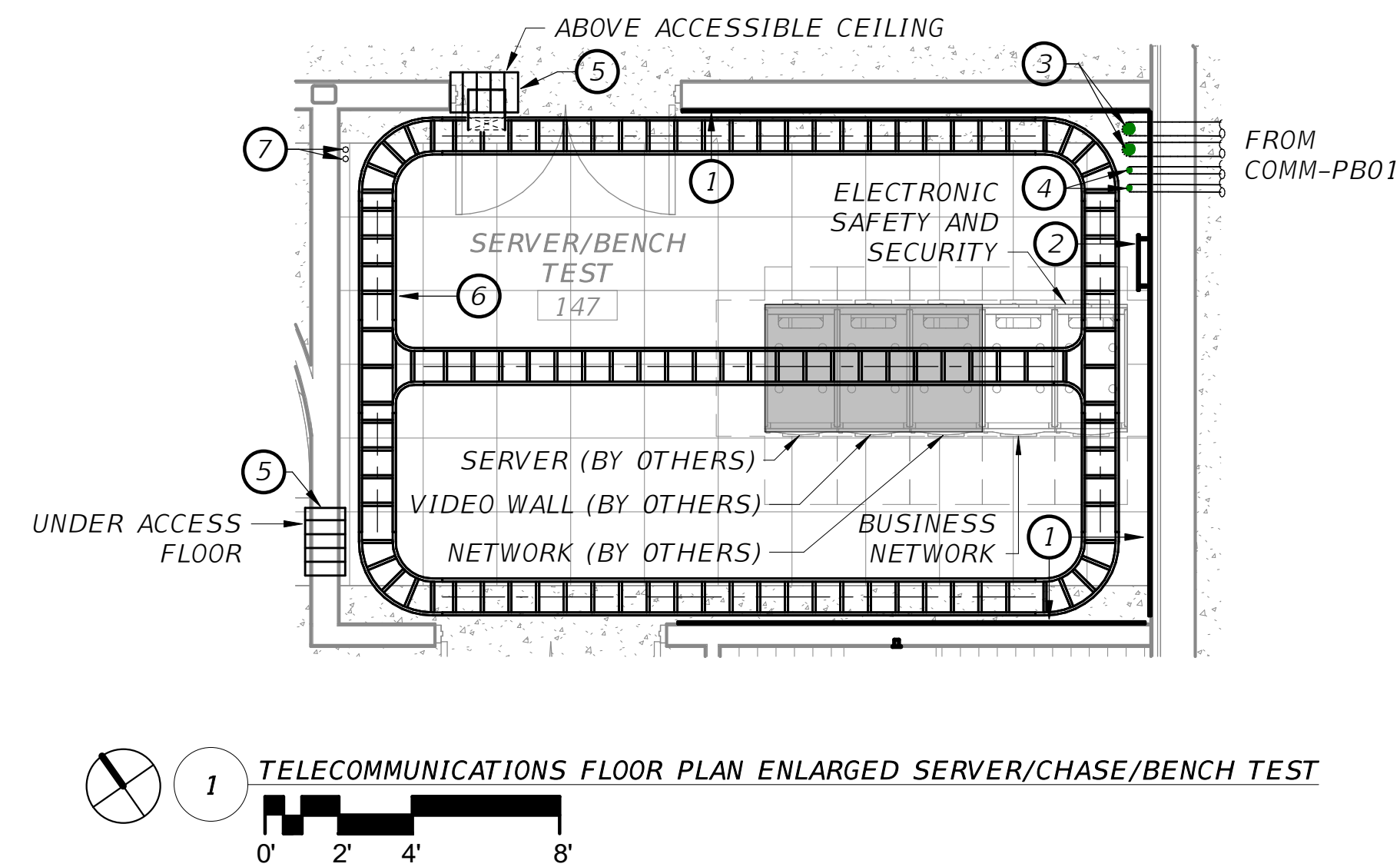

THIS ITEM HAS BEEN DIGITALLY SIGNED AND SEALED BY  
 ON THE DATE ADJACENT TO THE SEAL  
 PRINTED COPIES OF THIS DOCUMENT ARE NOT CONSIDERED SIGNED AND SEALED AND THE SIGNATURE MUST BE VERIFIED ON ANY ELECTRONIC COPIES.

No.	Date	Issue / Revision



GABRIEL BENAVIDES JR. P.E.  
 PE NO. 97009  
 HALFF ASSOCIATES, INC.  
 2255 KILLEARN CENTER BLVD.  
 SUITE 200  
 TALLAHASSEE, FL 32309

FLORIDA-ALABAMA TPO		
ROAD NO.	COUNTY	FINANCIAL PROJECT ID
NORTH W STREET	ESCAMBIA	451524-1-38-01

**TELECOMMUNICATIONS ENLARGED PLANS**

<b>DWG NO.</b>	TN201
<b>SHEET NO.</b>	

THE OFFICIAL RECORD OF THIS SHEET IS THE ELECTRONIC FILE DIGITALLY SIGNED AND SEALED UNDER RULE 61G15-23.004, F.A.C.



**TELECOMMUNICATIONS PATCH PANEL 1**

Location: SERVER/BENCH TEST 147

CKT	Circuit Description
1	ACCESS POINT -1 - CORRIDOR 120.4
2	ACCESS POINT -2 - CORRIDOR 120.2
3	ACCESS POINT -3 - OPEN OFFICE 120
4	ACCESS POINT -4 - RTMC TRAINING/MEETING ROOM 132
5	ACCESS POINT -5 - RTMC TRAINING/MEETING ROOM 132
6	ACCESS POINT -6 - CONTROL ROOM 148
7	ACCESS POINT -7 - MEDIA COVERAGE ROOM 139
8	ACCESS POINT -8 - CONTROL ROOM 148
9	DATA - MEDIA ROOM 107
10	DATA - MEDIA ROOM 107
11	DATA - OFFICE 101
12	DATA - OFFICE 101
13	DATA - OFFICE 102
14	DATA - OFFICE 102
15	DATA - OFFICE 103
16	DATA - OFFICE 103
17	DATA - OFFICE 104
18	DATA - OFFICE 104
19	DATA - OFFICE 105
20	DATA - OFFICE 105
21	DATA - COLLAB OFFICE 121
22	DATA - COLLAB OFFICE 121
23	DATA - COLLAB OFFICE 122
24	DATA - COLLAB OFFICE 122
25	DATA - COLLAB OFFICE 123
26	DATA - COLLAB OFFICE 123
27	DATA FLOOR BOX - AUTO COLLABORATION 108
28	DATA FLOOR BOX - AUTO COLLABORATION 108
29	DATA FLOOR BOX - NEXUS CONFERENCE 109
30	DATA - OPEN OFFICE 120
31	DATA - OPEN OFFICE 120
32	DATA - MECH 149
33	DATA - ELEC 150
34	DATA - UPS 153
35	DATA - DIGITAL RECEPTION 118
36	
37	
38	
39	
40	
41	
42	
43	
44	
45	
46	
47	
48	

**TELECOMMUNICATIONS PATCH PANEL 2**

Location: SERVER/BENCH TEST 147

CKT	Circuit Description
1	DATA FLOOR BOX - CONTROL ROOM 148
2	DATA FLOOR BOX - CONTROL ROOM 148
3	DATA FLOOR BOX - CONTROL ROOM 148
4	DATA FLOOR BOX - CONTROL ROOM 148
5	DATA FLOOR BOX - CONTROL ROOM 148
6	DATA FLOOR BOX - CONTROL ROOM 148
7	DATA FLOOR BOX - CONTROL ROOM 148
8	DATA FLOOR BOX - CONTROL ROOM 148
9	DATA FLOOR BOX - CONTROL ROOM 148
10	DATA FLOOR BOX - CONTROL ROOM 148
11	DATA FLOOR BOX - CONTROL ROOM 148
12	DATA FLOOR BOX - CONTROL ROOM 148
13	DATA FLOOR BOX - CONTROL ROOM 148
14	DATA FLOOR BOX - CONTROL ROOM 148
15	DATA FLOOR BOX - CONTROL ROOM 148
16	DATA FLOOR BOX - CONTROL ROOM 148
17	DATA FLOOR BOX - CONTROL ROOM 148
18	DATA FLOOR BOX - CONTROL ROOM 148
19	DATA FLOOR BOX - CONTROL ROOM 148
20	DATA FLOOR BOX - CONTROL ROOM 148
21	DATA FLOOR BOX - CONTROL ROOM 148
22	DATA FLOOR BOX - CONTROL ROOM 148
23	DATA FLOOR BOX - CONTROL ROOM 148
24	DATA FLOOR BOX - CONTROL ROOM 148
25	DATA FLOOR BOX - MEDIA COVERAGE ROOM 139
26	DATA - OFFICE 140
27	DATA - OFFICE 140
28	DATA - OFFICE 141
29	DATA - OFFICE 141
30	DATA - OFFICE 142
31	DATA - OFFICE 142
32	DATA - OFFICE 143
33	DATA - OFFICE 143
34	DATA - OFFICE 144
35	DATA - OFFICE 144
36	DATA - OFFICE 145
37	DATA - OFFICE 145
38	DATA - OFFICE 146
39	DATA - OFFICE 146
40	
41	
42	
43	
44	
45	
46	
47	
48	

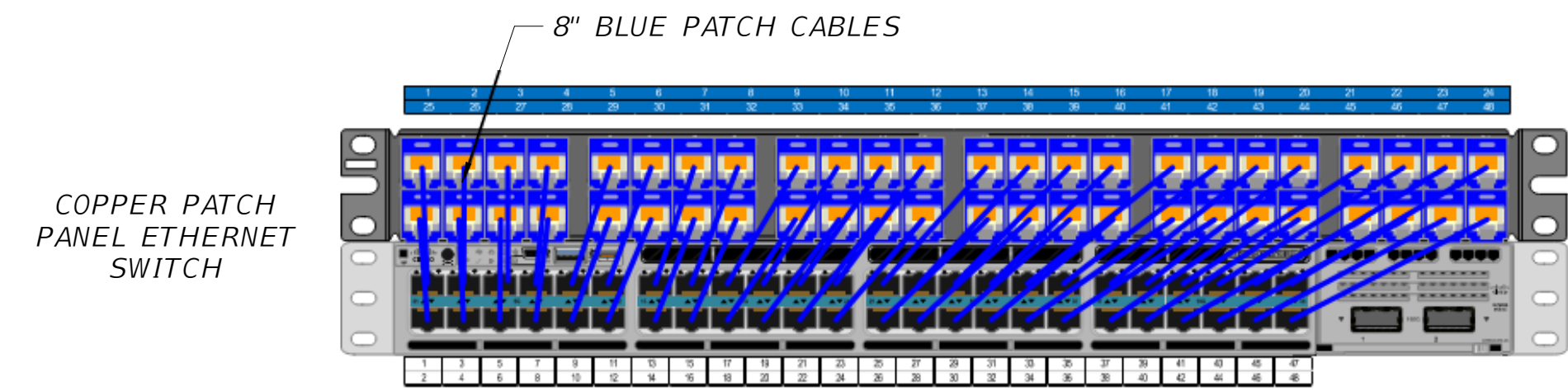

1 TYPICAL COPPER PATCH PANEL JACK TO ETHERNET SWITCH PORT DETAIL

BUSINESS NETWORK CABINET 4

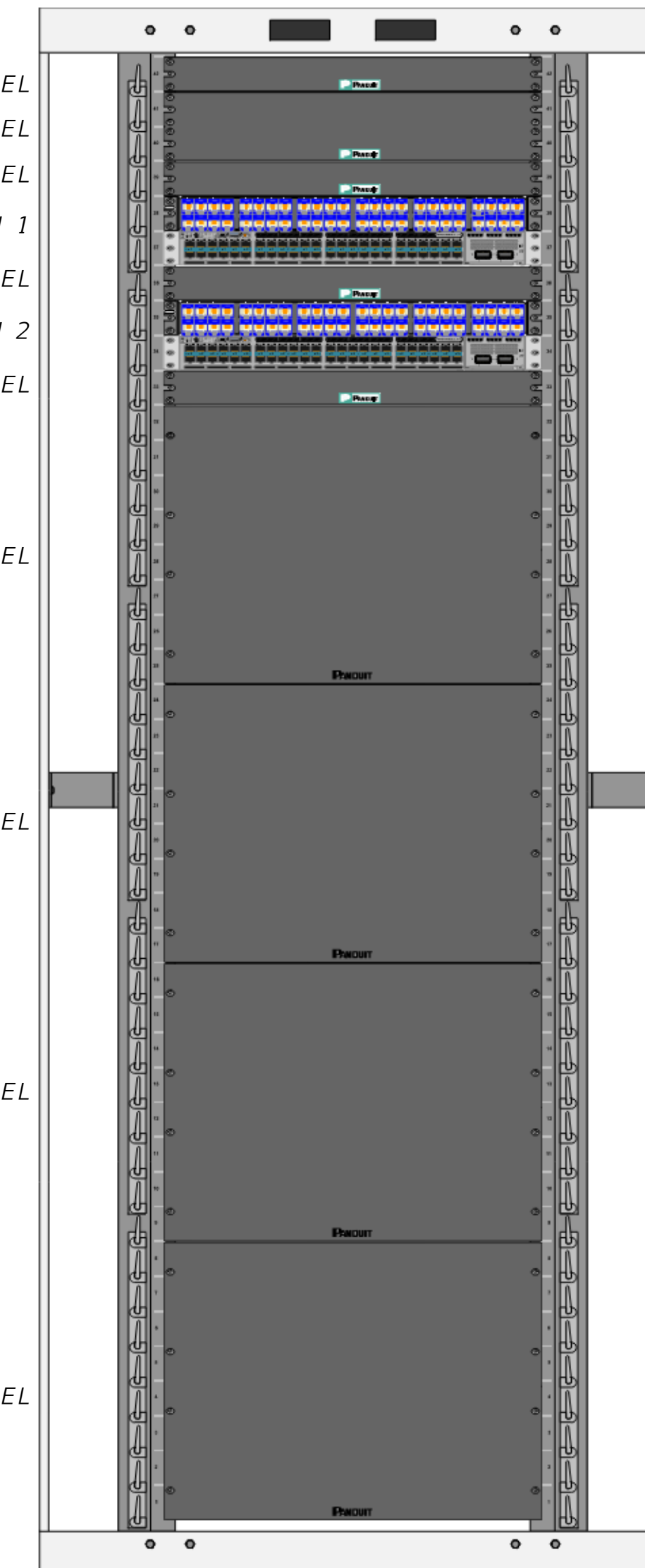

FRONT VIEW

BUSINESS NETWORK CABINET 4

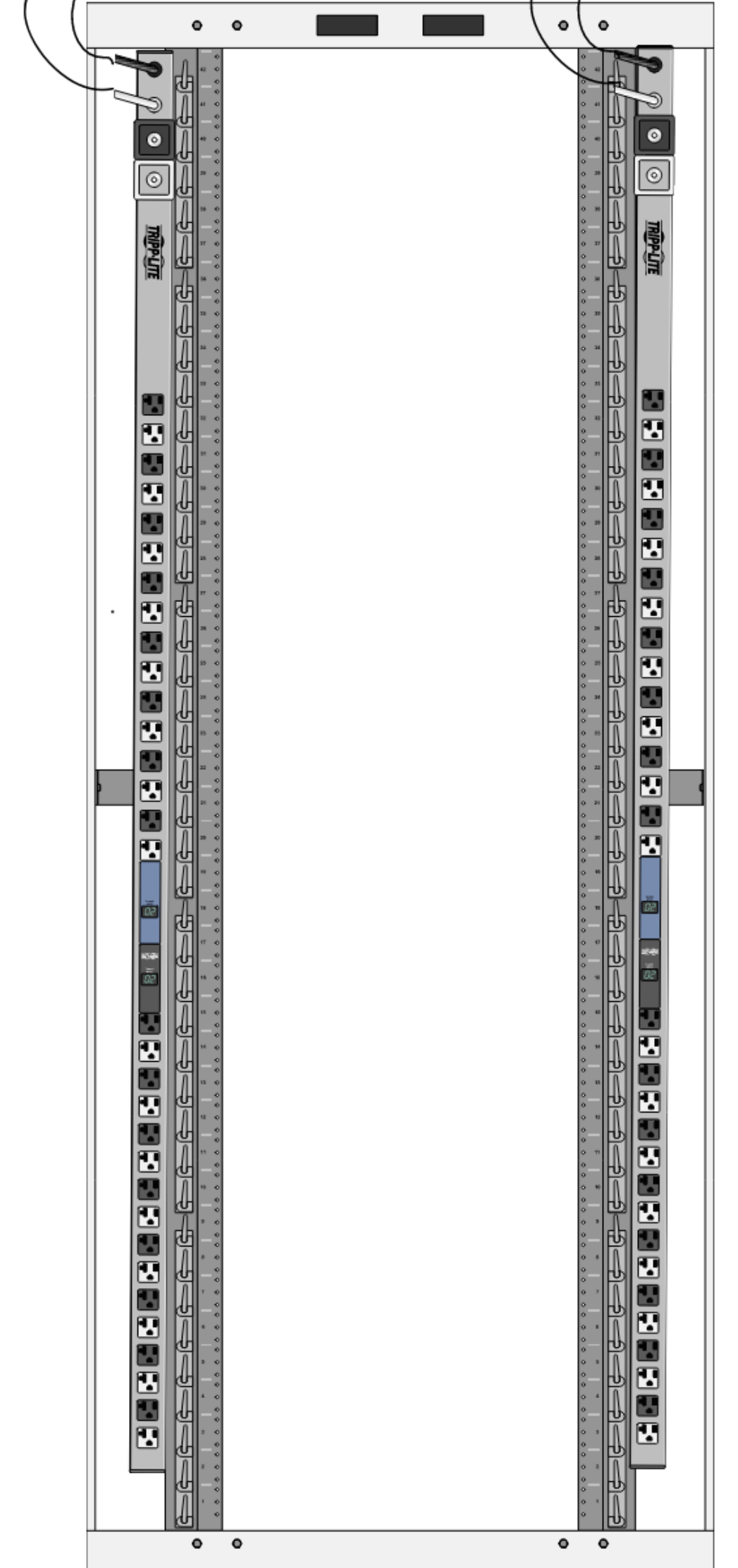

REAR VIEW

FILLER PANEL  
 FILLER PANEL  
 FILLER PANEL  
 (BLUE) TELECOMMUNICATIONS PANEL 1/SWITCH 1  
 FILLER PANEL  
 (BLUE) TELECOMMUNICATIONS PANEL 2/SWITCH 2  
 FILLER PANEL  
 FILLER PANEL  
 FILLER PANEL  
 FILLER PANEL  
 FILLER PANEL  
 FILLER PANEL

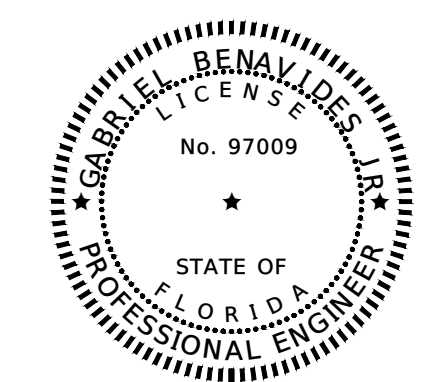

THIS ITEM HAS BEEN DIGITALLY SIGNED AND SEALED BY  
 ON THE DATE ADJACENT TO THE SEAL  
 PRINTED COPIES OF THIS DOCUMENT ARE NOT CONSIDERED SIGNED AND SEALED AND THE SIGNATURE MUST BE VERIFIED ON ANY ELECTRONIC COPIES.

No.	Date	Issue / Revision



GABRIEL BENAVIDES JR. P.E.  
 PE NO. 97009  
 HALFF ASSOCIATES, INC.  
 2255 KILLEARN CENTER BLVD.  
 SUITE 200  
 TALLAHASSEE, FL 32309

FLORIDA-ALABAMA TPO		
ROAD NO.	COUNTY	FINANCIAL PROJECT ID
NORTH W STREET	ESCAMBIA	451524-1-38-01

**TELECOMMUNICATIONS SCHEDULES**

<b>DWG NO.</b>	TN401
<b>SHEET NO.</b>	

THE OFFICIAL RECORD OF THIS SHEET IS THE ELECTRONIC FILE DIGITALLY SIGNED AND SEALED UNDER RULE 61G15-23.004, F.A.C.



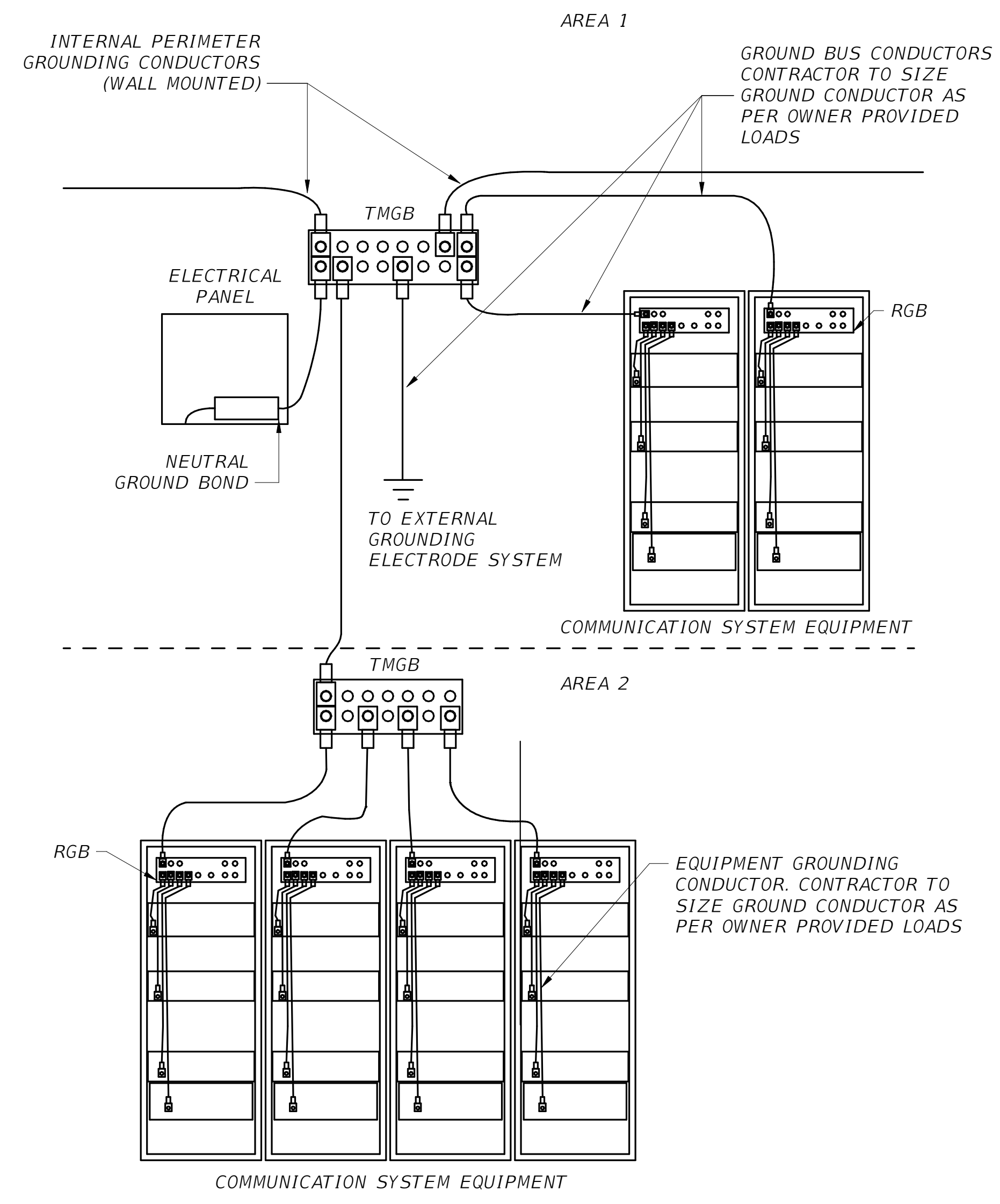

9 TYPICAL SINGLE-POINT INTERNAL GROUNDING SYSTEM

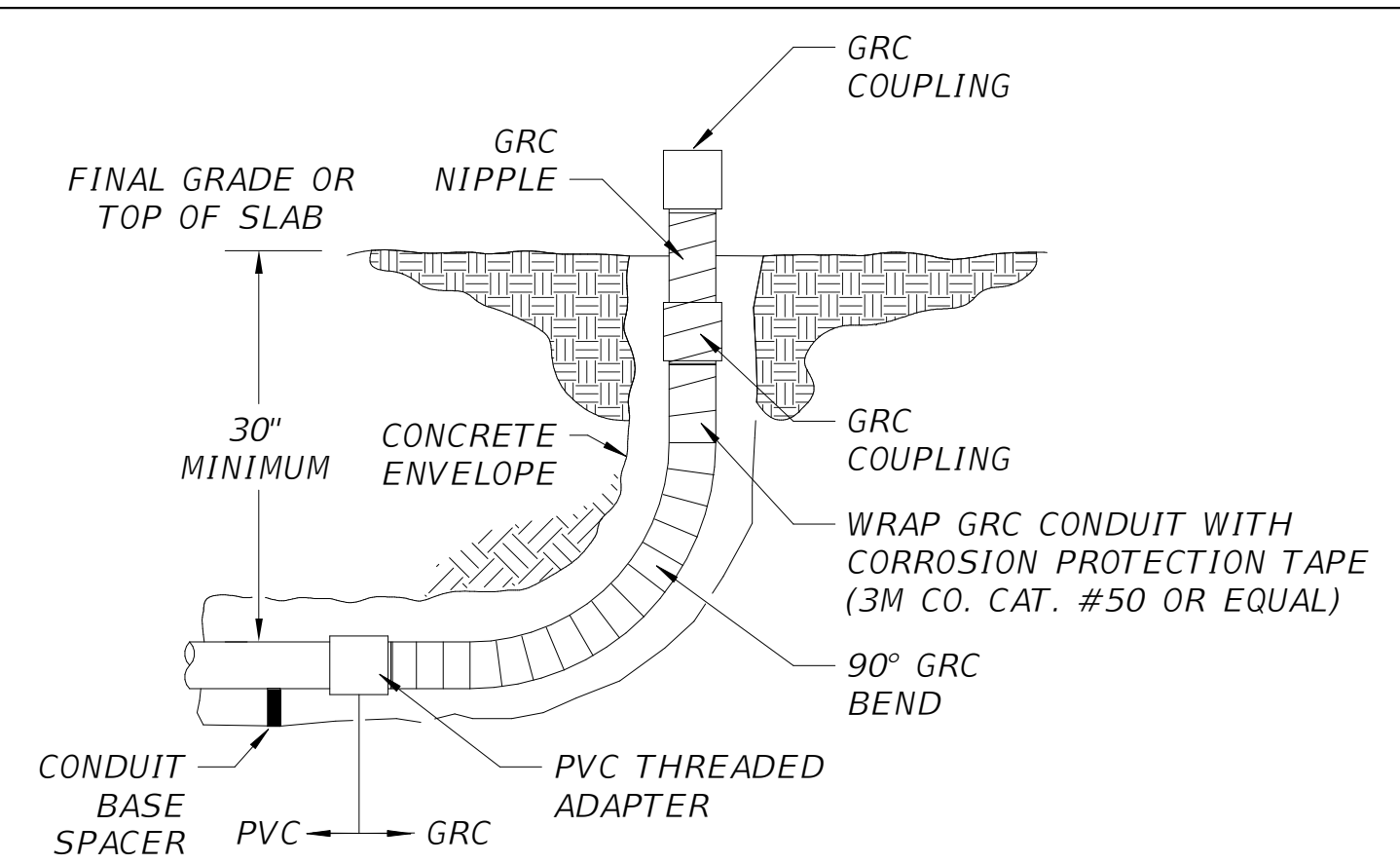

8 TYPICAL CONDUIT STUB-UP DETAIL

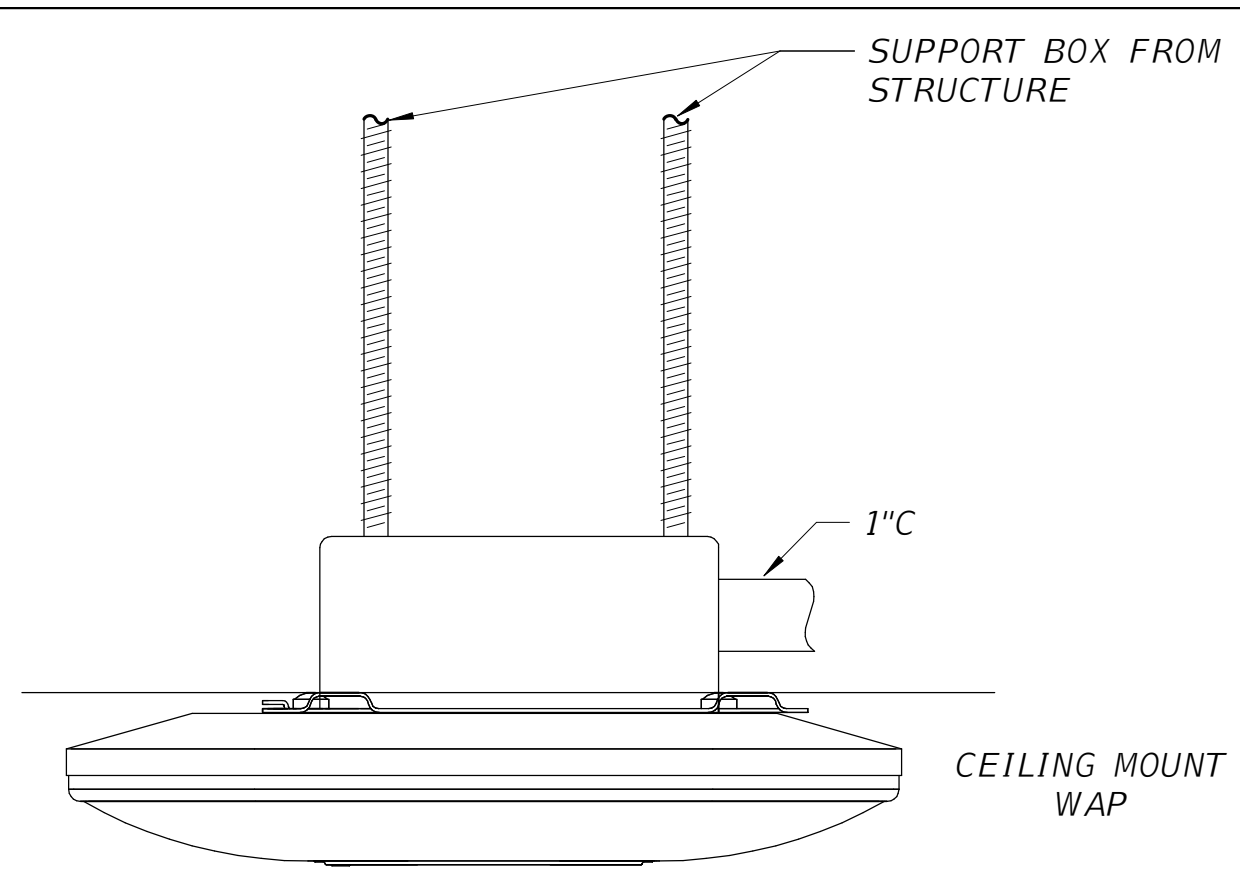

7 WIRELESS ACCESS POINT MOUNTING DETAIL

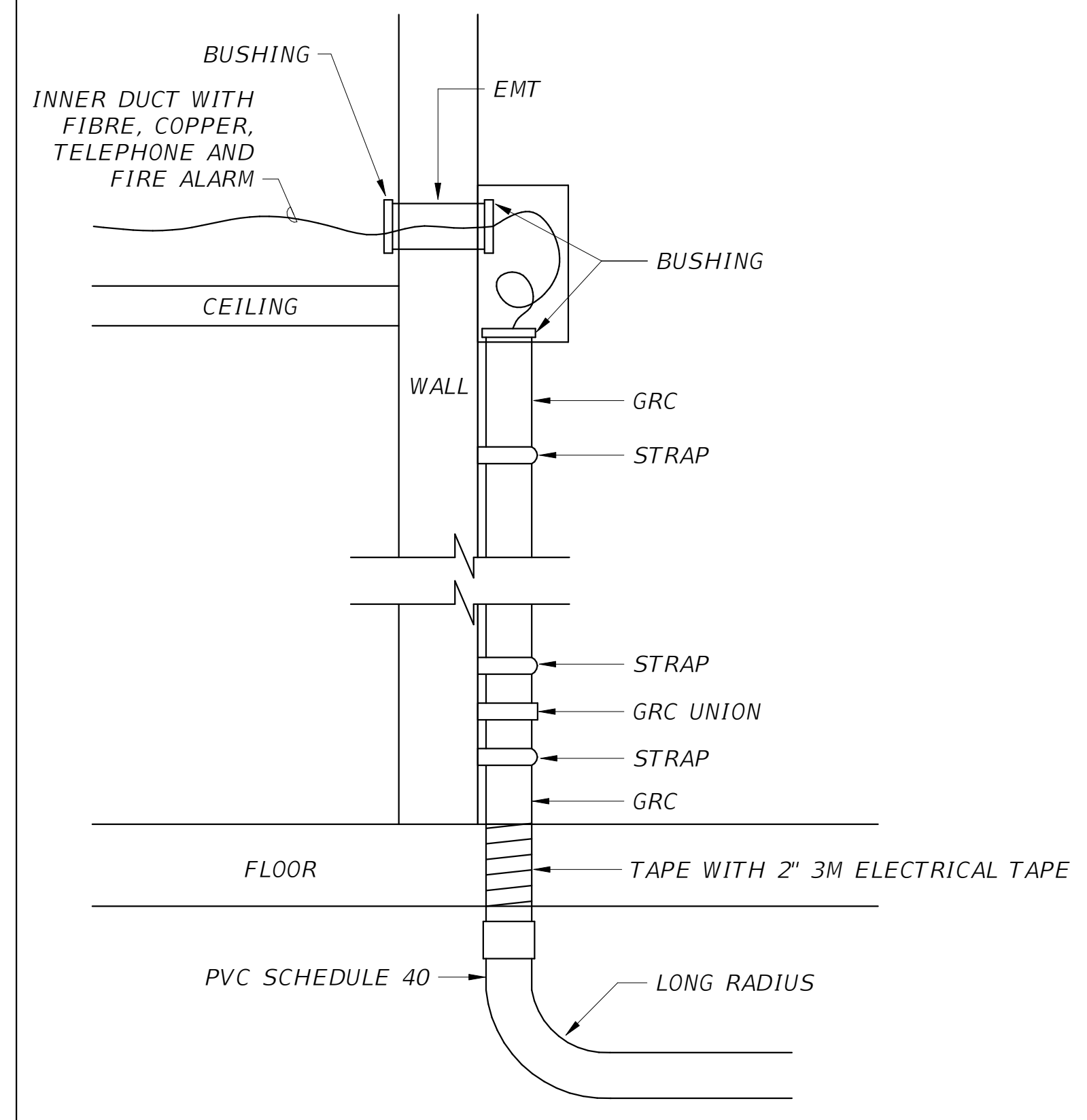

6 WALL PENETRATION DETAIL

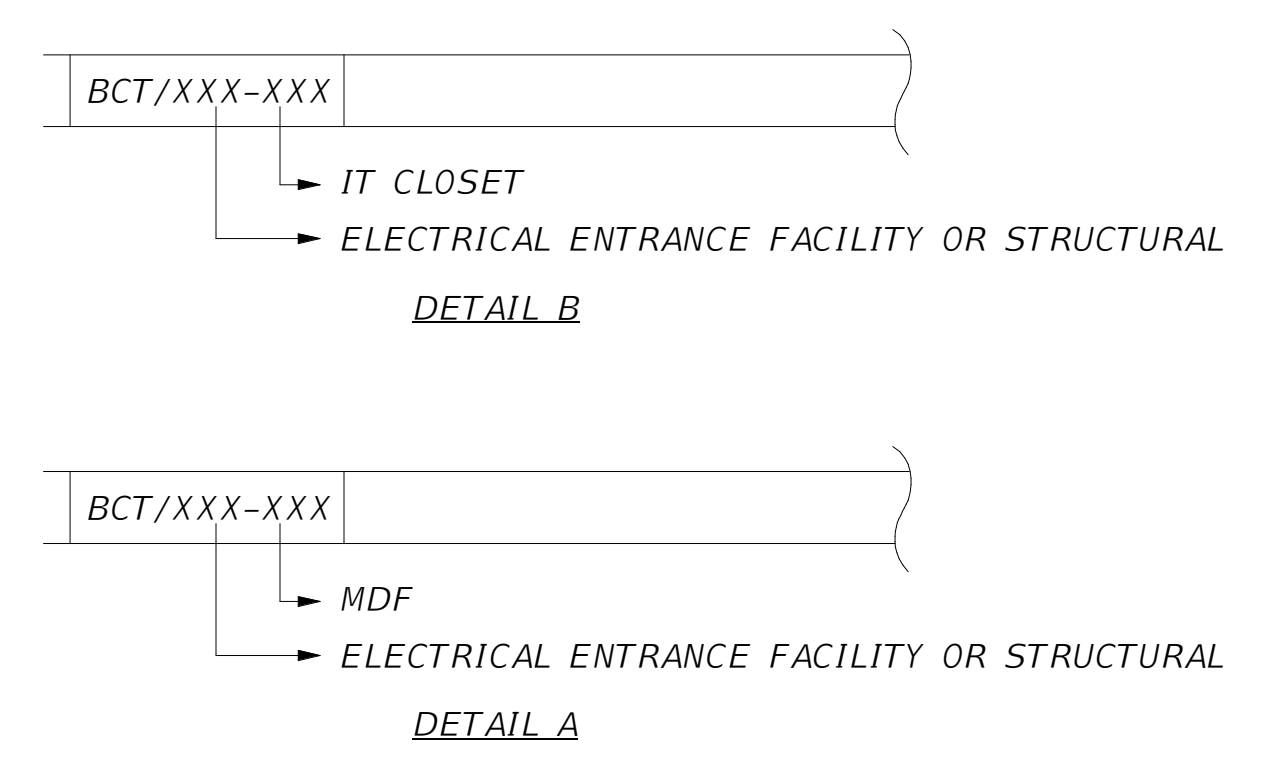

5 BONDING CONDUCTOR LABEL DETAIL

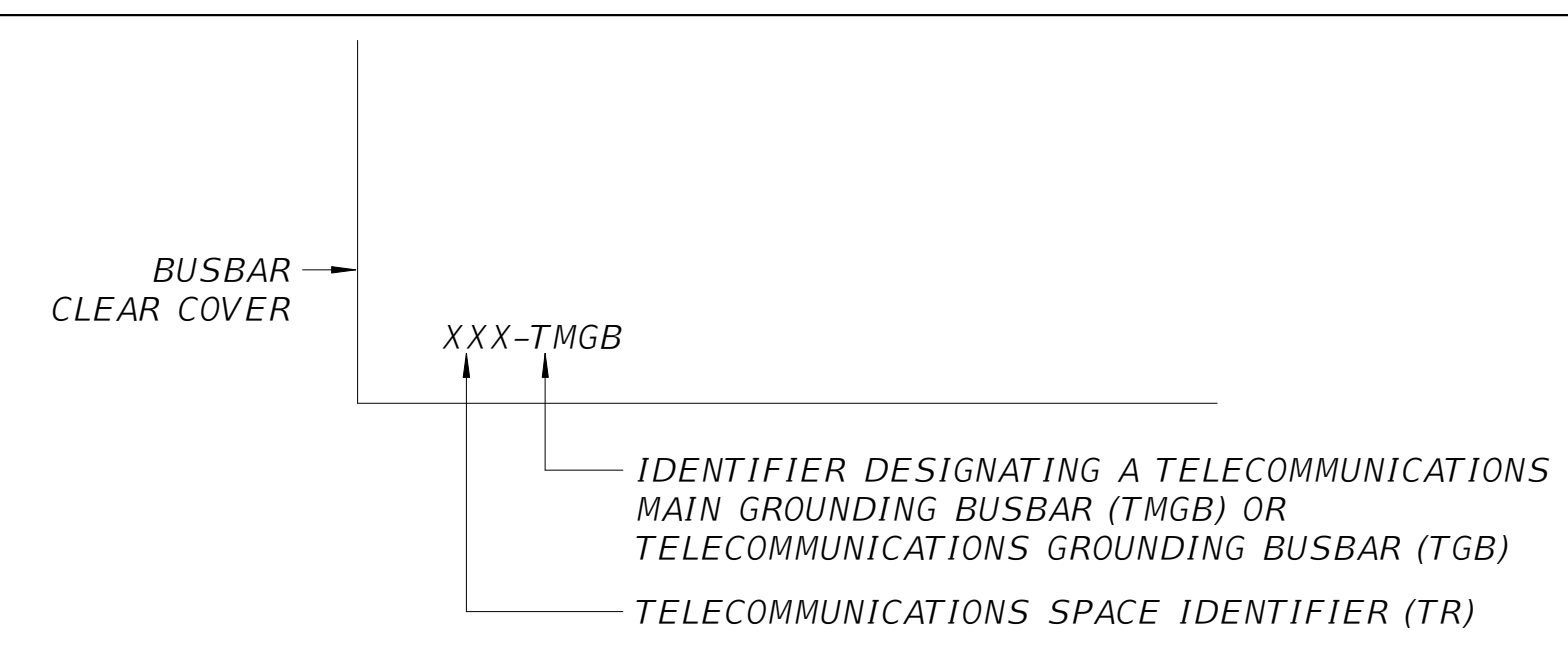

4 GROUNDING BUSBAR LABEL DETAIL

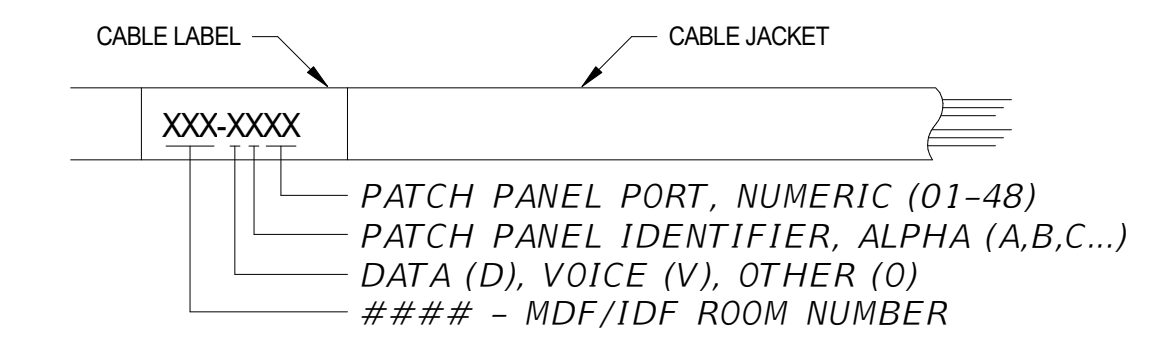

NOTES:  
1. DETAIL SHOWN REPRESENTS A 4-PAIR HORIZONTAL LINK TERMINATING IN A TELECOMMUNICATIONS SPACE ON A RACK MOUNT PATCH PANEL.

3 HORIZONTAL LINK CABLE LABEL DETAIL

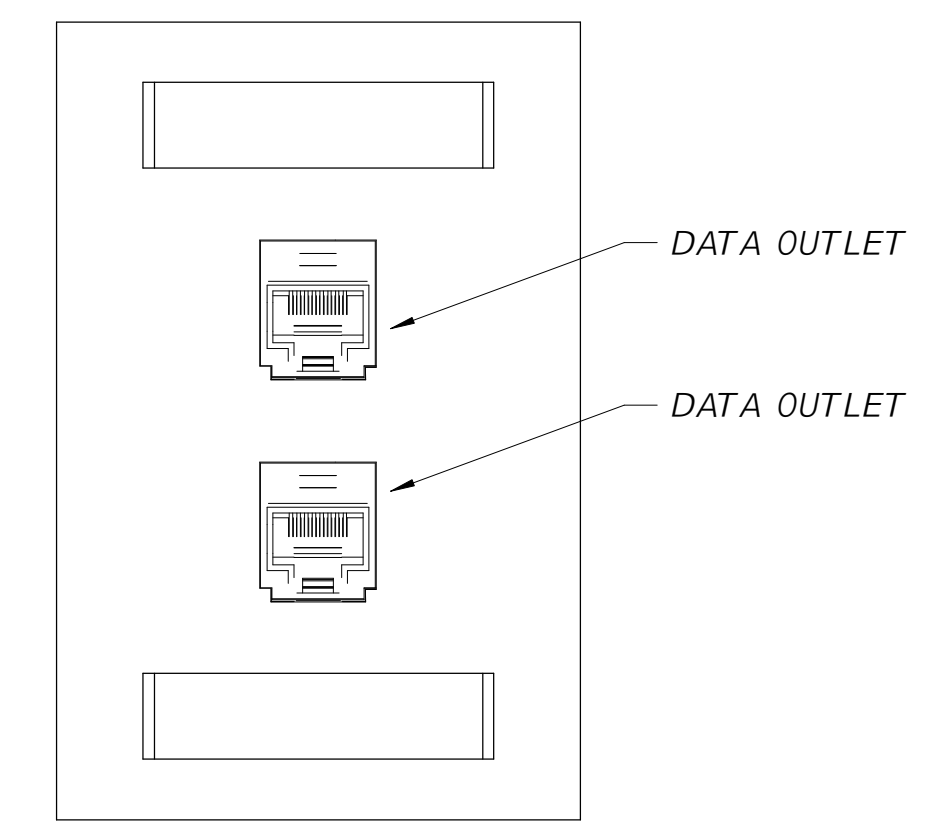

2 TWO PORT OUTLET

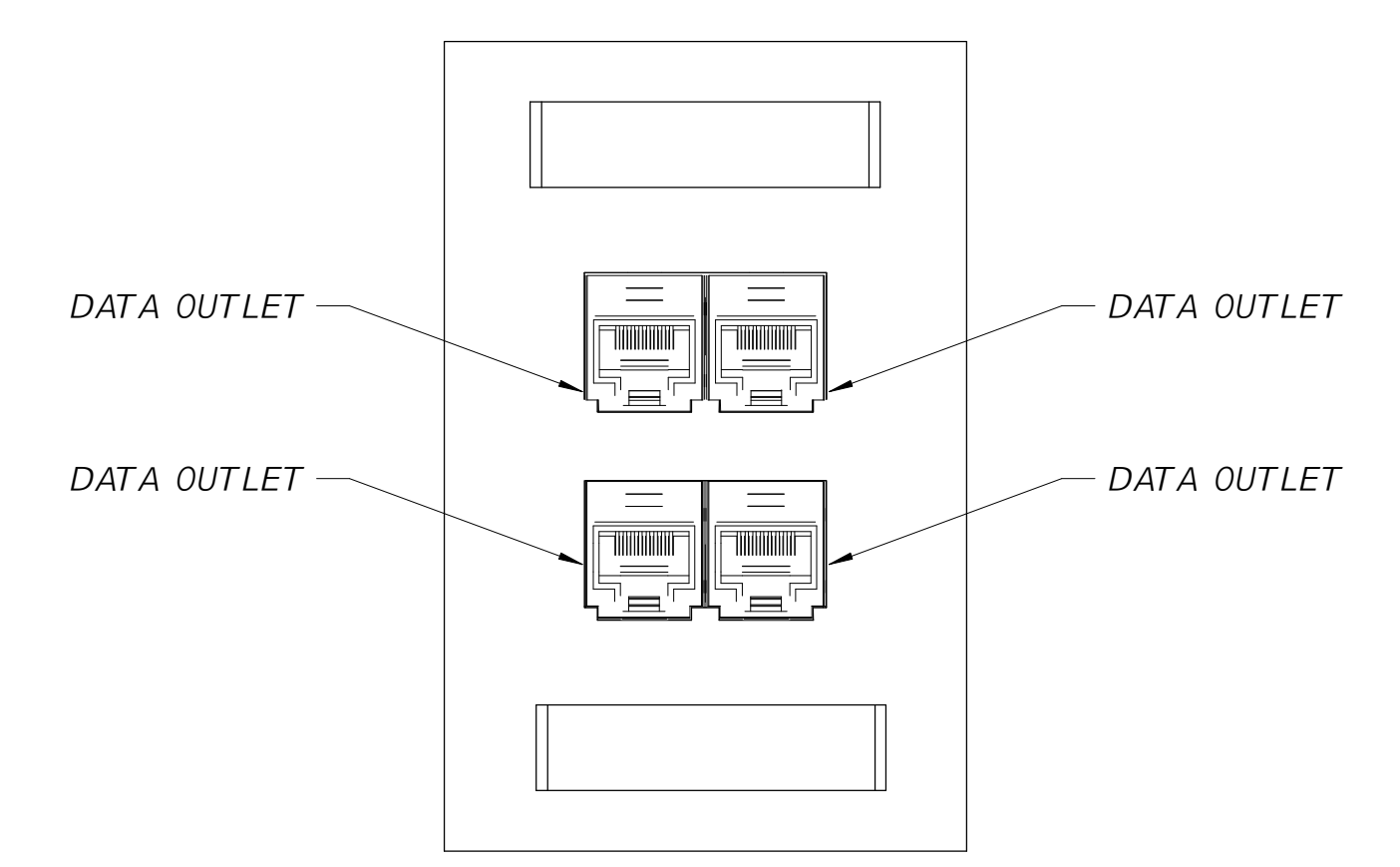

1 FOUR PORT OUTLET

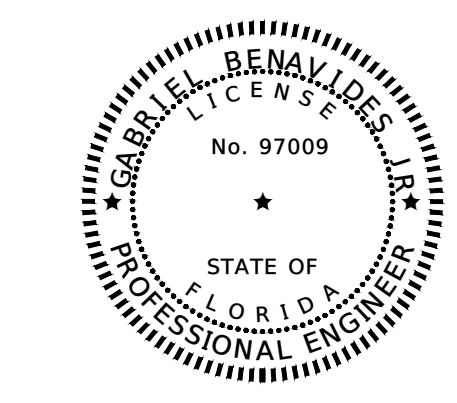

THIS ITEM HAS BEEN DIGITALLY SIGNED AND SEALED BY  
ON THE DATE ADJACENT TO THE SEAL  
PRINTED COPIES OF THIS DOCUMENT ARE NOT CONSIDERED SIGNED AND SEALED AND THE SIGNATURE MUST BE VERIFIED ON ANY ELECTRONIC COPIES.

No.	Date	Issue / Revision

**halff**  
2255 KILLEARN CENTER BLVD.  
SUITE 200  
TALLAHASSEE, FLORIDA 32309  
TEL. (850) 224-4400

GABRIEL BENAVIDES JR. P.E.  
PE NO. 97009  
HALFF ASSOCIATES, INC.  
2255 KILLEARN CENTER BLVD.  
SUITE 200  
TALLAHASSEE, FL 32309

FLORIDA-ALABAMA TPO		
ROAD NO.	COUNTY	FINANCIAL PROJECT ID
NORTH W STREET	ESCAMBIA	451524-1-38-01

TELECOMMUNICATIONS DETAILS I

DWG NO.	TN501
SHEET NO.	

THE OFFICIAL RECORD OF THIS SHEET IS THE ELECTRONIC FILE DIGITALLY SIGNED AND SEALED UNDER RULE 61G15-23.004, F.A.C.



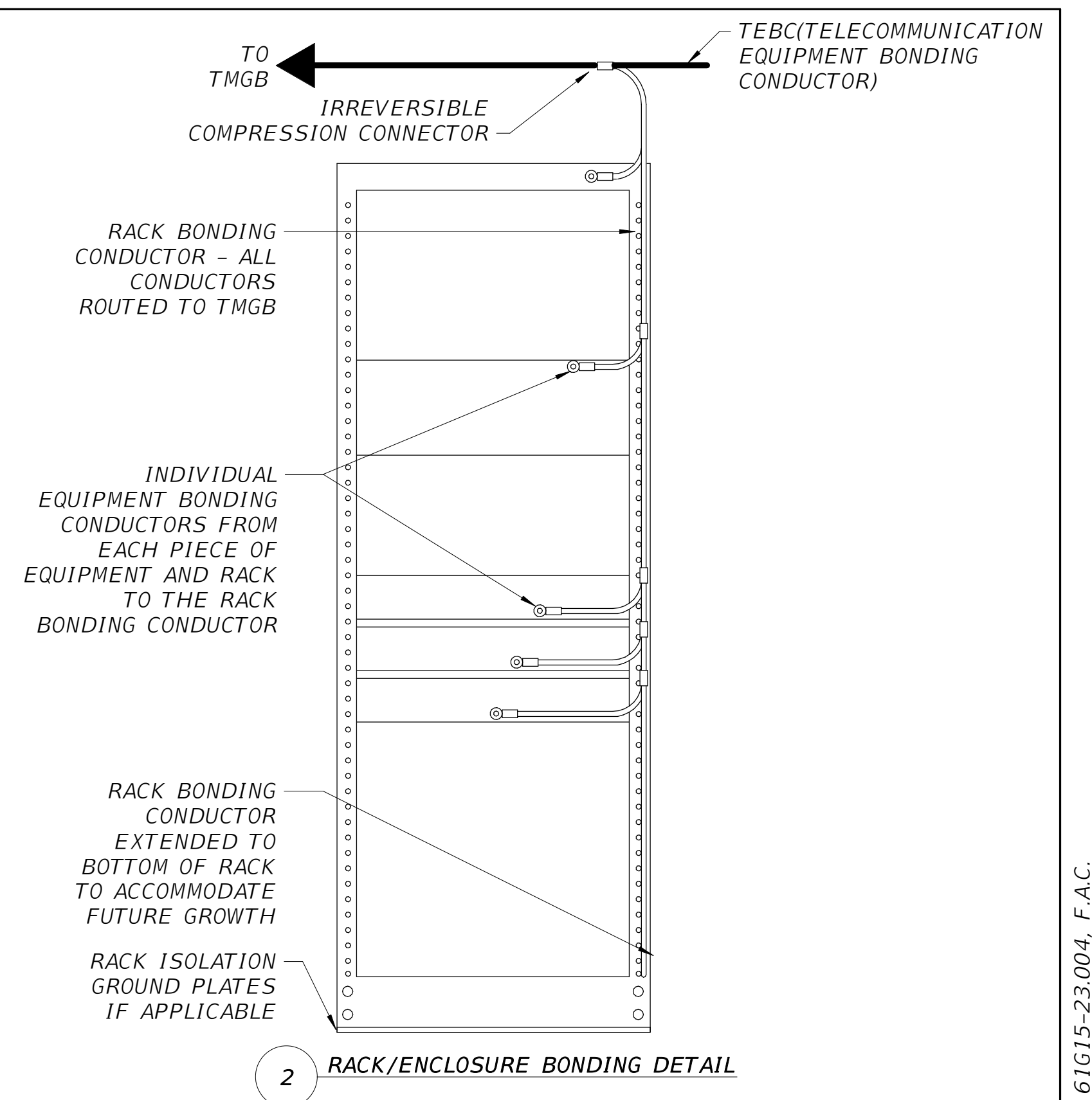

2 RACK/ENCLOSURE BONDING DETAIL

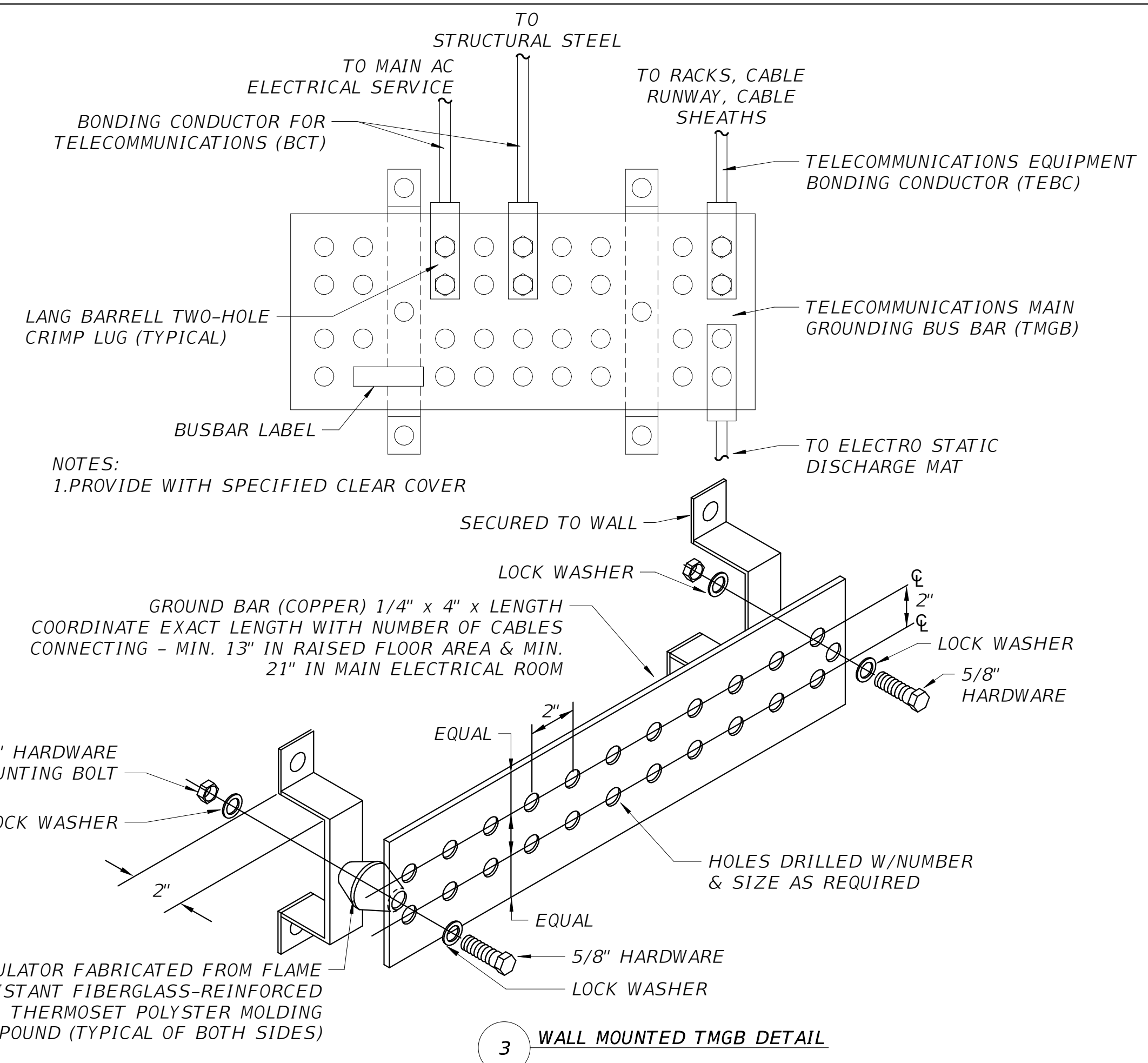

3 WALL MOUNTED TMGB DETAIL

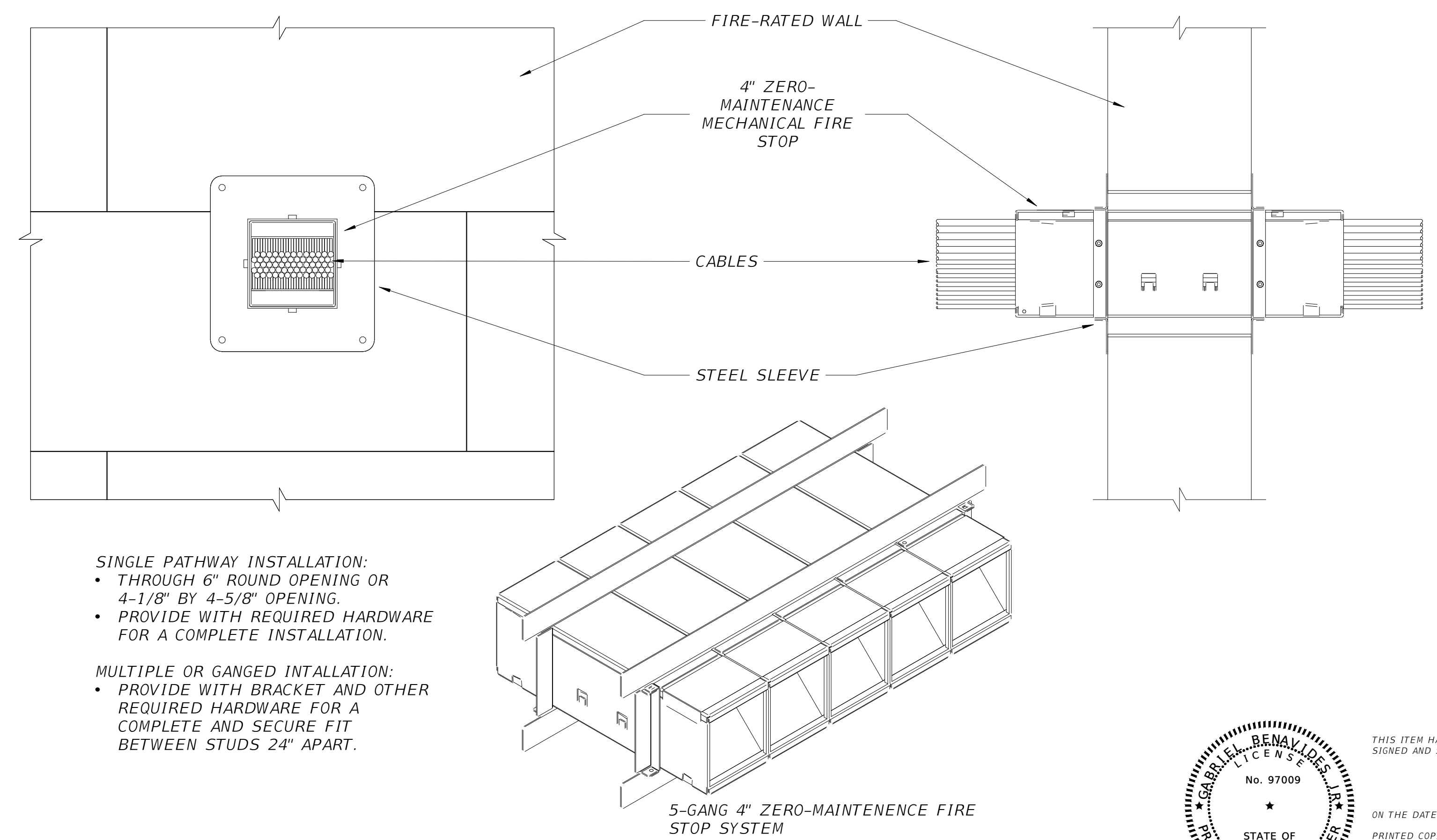

- SINGLE PATHWAY INSTALLATION:**
- THROUGH 6" ROUND OPENING OR 4-1/8" BY 4-5/8" OPENING.
  - PROVIDE WITH REQUIRED HARDWARE FOR A COMPLETE INSTALLATION.
- MULTIPLE OR GANGED INTALLATION:**
- PROVIDE WITH BRACKET AND OTHER REQUIRED HARDWARE FOR A COMPLETE AND SECURE FIT BETWEEN STUDS 24" APART.

1 ZERO-MAINTENANCE MECHANICAL TYPE FIRE STOP SYSTEM

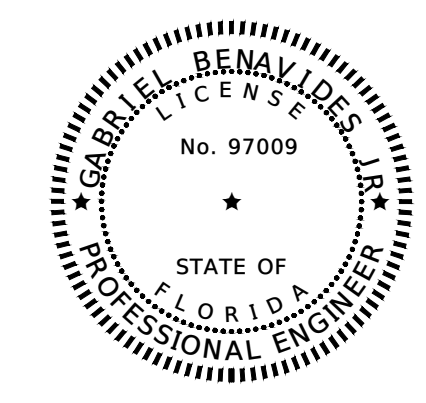

THIS ITEM HAS BEEN DIGITALLY SIGNED AND SEALED BY  
 ON THE DATE ADJACENT TO THE SEAL  
 PRINTED COPIES OF THIS DOCUMENT ARE NOT CONSIDERED SIGNED AND SEALED AND THE SIGNATURE MUST BE VERIFIED ON ANY ELECTRONIC COPIES.

No.	Date	Issue / Revision



GABRIEL BENAVIDES JR. P.E.  
 PE NO. 97009  
 HALFF ASSOCIATES, INC.  
 2255 KILLEARN CENTER BLVD.  
 SUITE 200  
 TALLAHASSEE, FL 32309

FLORIDA-ALABAMA TPO		
ROAD NO.	COUNTY	FINANCIAL PROJECT ID
NORTH W STREET	ESCAMBIA	451524-1-38-01

TELECOMMUNICATIONS DETAILS II

DWG NO.	TN502
SHEET NO.	

THE OFFICIAL RECORD OF THIS SHEET IS THE ELECTRONIC FILE DIGITALLY SIGNED AND SEALED UNDER RULE 61G15-23.004, F.A.C.